

**COUNTY OF LOS ANGELES**  
**ROAD DEPARTMENT**

**PRECISE**  
**BENCH MARK LIST**



**LIEBRE QUAD**

**1973 ADJUSTMENT**

**(LANCASTER WEST)**  
**NAVD29 DATUM**

## PREFACE

The Road Department level net is composed of more than 1,000 miles of levels supporting in excess of 10,000 bench marks. In 1964-65, a major readjustment of the net was undertaken. To emphasize the complete break with previous elevations, the SY, SG & SL series bench marks have been re-labeled BY, BG & BL, respectively.

To facilitate the adjustment, indexing, and distribution of adjusted values of the net, the County territory was divided into 31 quads or areas. For identification purposes each quad was given a name, viz., "Rosemead," "La Mirada," "Santa Fe," etc. When bench marks and elevations in the Road Department net are used, the name of the quad in which the bench mark is located and the date of the adjustment of the elevation must be included in the bench mark description, e.g.,

BG 1887 --L+BN IN CONC HDWL OF DRAIN PIPE UNDER DR 218 FT  
NE +18 FT SE C/L INT GRAND AVE +CAMERON AVE MKD (BM)  
(COVINA --1965) ELEV. 696.238

It is expected that this general adjustment will, for the most part, remain sound for the next 8 to 12 years. As new circuits are completed, however, re-adjustment of individual quads may become advisable. It is expected that these subsequent adjustments will be in the nature of a few hundredths of a foot. When a quad is re-adjusted, new elevation lists will be published and the date of the re-adjustment will replace the "1965" at the end of the bench mark description. Two bench marks in the same quad with different adjustment dates will not normally join each other. Since all adjustments taper out to nothing at the periphery of the quad, any bench mark in one quad will join any bench mark in another quad regardless of their respective adjustment dates.

The basic accuracy of the net is reflected by an indicated field probable error of plus or minus 0.012 foot per mile of leveling as determined from 298 conditions of closure. However, many years experience in vertical control in the greater Los Angeles basin and Antelope Valley indicate that because of varying degrees of subsidence and heaving, the true datum is recovered only by obtaining substantial agreement of a number of bench marks.

The users of this net are invited to assist in its maintenance by notifying this Department of cases of obliteration, apparent mistakes in descriptions or elevations, and proven disturbance of bench marks.

---

DATUM: U. S. Coast and Geodetic Survey Sea Level Datum  
of 1929, through the medium of the Los Angeles  
County Engineer Precise Level Net, 1963 Adjust-  
ment.

ABBREVIATIONS USED IN BENCH MARK LISTINGS

ABUT - - - - -	Abutment	EC - - - - -	End of Curve
ALG - - - - -	Along	ENT - - - - -	Entrance
ANG PT - - - - -	Angle Point	FL - - - - -	Floor
B/W - - - - -	Back of Walk	FTG - - - - -	Footing
BCR - - - - -	Beginning of Curb Return	F/W - - - - -	Front of Walk
BC - - - - -	Beginning of Curve	GAR - - - - -	Garage
BLDG - - - - -	Building	HDWL - - - - -	Headwall
EM - - - - -	Bench Mark	HSE - - - - -	House
BT SPK - - - - -	Boat or Bolt Spike	INT - - - - -	Intersection
BR CAP - - - - -	Brass or Bronze Cap	IP - - - - -	Iron Pipe
C B - - - - -	Catch Basin	LT - - - - -	Left
CTR - - - - -	Center	LACE - - - - -	L. A. City Engineer
C/L - - - - -	Center Line	LACS - - - - -	L. A. County Engineer
C/L INT - - - - -	Center Line Intersection	LAFC - - - - -	L. A. Co. Flood Control
C/L PROD - - - - -	Center Line Produced	L+BN - - - - -	Lead and Bench Nail
CONC - - - - -	Concrete	L+BR - - - - -	Lead and Brad
COR - - - - -	Corner	L+N - - - - -	Lead and Nail
COE - - - - -	Corps of Engineers	L+RDEM TAG - - - - -	Lead and Road Dept. Bench Mark Tag
CULV - - - - -	Culvert	L+SPK - - - - -	Lead and Spike
CB - - - - -	Curb	L+T - - - - -	Lead and Tack
CS MON - - - - -	County Engineer Monument	MCR - - - - -	Middle of Curb Return
CS BR CAP - - - - -	County Engineer Brass Cap	MKD - - - - -	Marked
CT SPK - - - - -	Cut Spike	MC - - - - -	Middle of Curve
DR - - - - -	Drive or Driveway	MON - - - - -	Monument
E/O - - - - -	East of	N/O - - - - -	North of
ECR - - - - -	End of Curb Return	NR - - - - -	Near

ABBREVIATIONS USED IN BENCH MARK LISTINGS . . . CONTINUED

OPP - - - - - Opposite  
PI - - - - - Point of Intersection  
PK+W - - - - - PK Nail and Washer  
P/L - - - - - Property Line  
POST - - - - - Point on Semi-Tangent  
PP - - - - - Power Pole  
PVMT - - - - - Pavement  
PROD - - - - - Produced  
RD - - - - - Road  
RDEM - - - - - Road Dept. Bench Mark  
RR - - - - - Railroad  
RT - - - - - Right  
R/W - - - - - Right of Way  
SDMH - - - - - Storm Drain Manhole  
SMH - - - - - Sewer Manhole  
SPK - - - - - Spike  
ST+W - - - - - Spike Tin and Washer  
S/O - - - - - South of  
TP - - - - - Telephone Pole  
USC+GS - - - - - U. S. Coast and Geodetic Survey  
USGS - - - - - U. S. Geological Survey  
WK - - - - - Walk  
W/O - - - - - West of



U A D

Q U A D

L A N C A S T E R

P A L M D A L E  
Q U A D

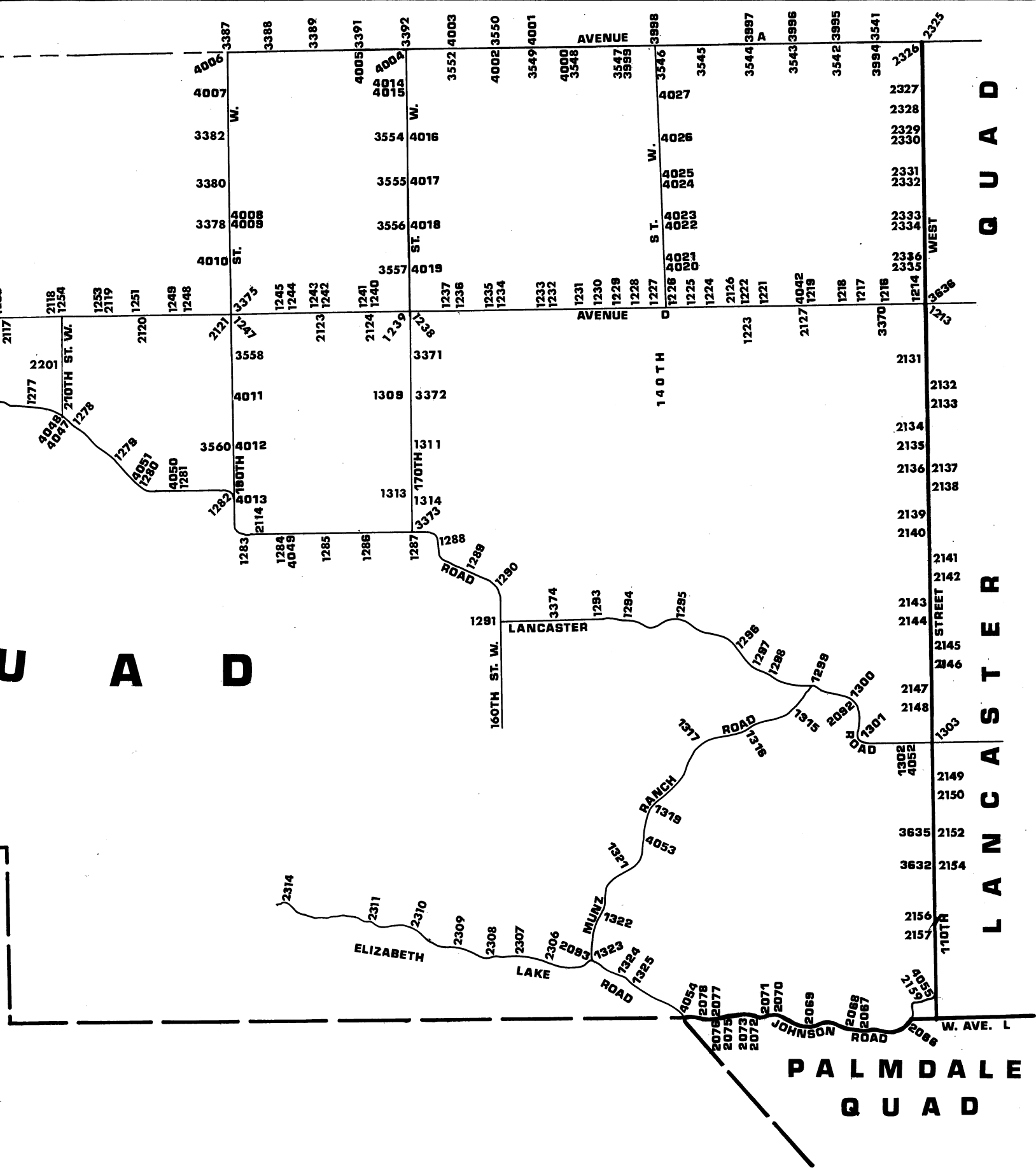

C O U N T Y

C O U N T Y

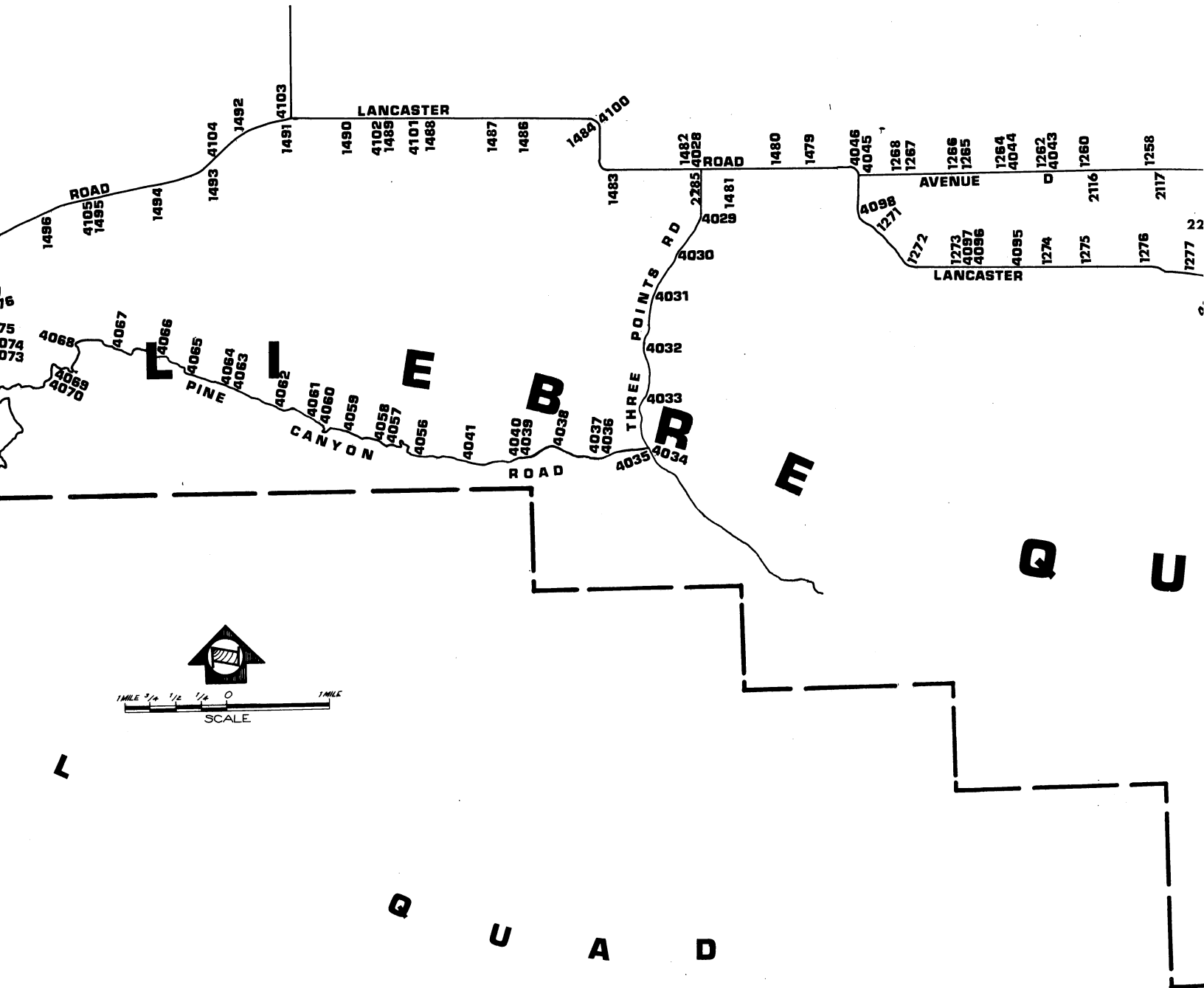

1 MILE 3/4 1/2 1/4 0 1 MILE  
SCALE

K E R N  
A N G E L E S

V E N T U R A

S O T  
C O U N T Y

GOLDEN

2878  
2875  
2874  
2872  
2871  
PEACE VALLEY RD

GORMAN SCHOOL ROAD

STATE FRWY

LANCASTER

1516  
1515  
1514  
1513  
1512

1511

1510

1508

1507

1506

4117

4118

4116

4115

4114

4113

4112

4111

4110

4109

4108

1500

4107

1499

1498

4106

1497

1496

ROAD

4105

1495

4099  
4098  
4097  
4096  
4095  
4094  
4093  
4092  
4091  
4090  
4089  
4088  
4087  
4086  
4085  
4084  
4083  
4082  
4081  
4080  
4079  
4078  
4077  
4076  
4075  
4074  
4073

4072  
4071

4068

4069

4070

4067

N E W H A L L

QUAD-YEAR	ELEV	DESCRIPTION (INCLUDE QUAD AND YEAR IN DESCRIPTION)	BM NUMBER
BASELINE (1965)	2485.338	CS MON (SW EDGE) IN WELL 14IN DN @ C/L INT AVE D + 110TH ST W MKD (SEC COR 13 14 23 24 T8N R14W)	BL 1213
LIEBRE (1973)	2487.960	RDBM MON 6FT E PP NO 1218851E 28FT N C/L AVE D + 235FT W C/L 110TH ST W 2IN IP WITNESS 3FT UP 2FT N	BL 1214
LIEBRE (1973)	2501.693	RDBM MON 6FT E PP NO 1218863E 45FT N C/L AVE D + 195FT W C/L 115TH ST W (DIRT RD) 2IN IP WITNESS 3FT UP 2FT N	BL 1216
LIEBRE (1973)	2513.497	RDBM TAG IN NWLY LEG OF W+P HIGH TENSION LINE TOWER NO 212-4 140FT N C/L AVE D + 165FT E C/L 120TH ST W (PROP BUT UNIMPROVED)	BL 1217
LIEBRE (1973)	2511.782	CS MON 15IN DN @ C/L INT AVE D + 120TH ST W (PROP BUT UNIMPROVED) MKD (T8N R14W SEC COR 14, 15,22,23) USE N EDGE	BL 1218
LIEBRE (1973)	2525.644	CS MON 24IN DN @ C/L INT AVE D + 125TH ST W (DIRT RD TO N) MKD (T8N R14W 1/4 SEC COR 15,22) (NE EDGE)	BL 1219
LIEBRE (1973)	2542.862	CS MON (N EDGE) IN WELL 18IN DN @ C/L INT AVE D + 130TH ST W MKD (SEC COR 15 16 21 22 T8N R14W)	BL 1221
LIEBRE (1973)	2545.573	USC+GS MON IN CONC POST 8IN UP 37FT S C/L AVE D + 31FT W C/L 130TH ST W (PROP BUT UNIMPROVED) MKD (WIND 1952)	BL 1222
LIEBRE (1973)	2545.204	USC+GS MON IN CONC POST 6IN UP 63FT S C/L AVE D + 29FT W C/L 130TH ST W (PROP BUT UNIMPROVED) MKD (WIND NO 1 1952)	BL 1223
LIEBRE (1973)	2576.465	RDBM TAG IN CONC BASE OF NELY LEG OF SO CALIF EDISON HIGH TENSION TOWER NO 51-4 200FT S C/L AVE D + 0.2 MI W 135TH ST W (PROP)	BL 1224
LIEBRE (1973)	2570.876	RDBM TAG IN CONC BASE OF SWLY LEG OF SO CALIF EDISON HIGH TENSION TOWER NO E51-3-A 60FT N C/L AVE D + 0.2MI W/O 135TH ST W PROPOSED	BL 1225
LIEBRE (1973)	2575.377	CS MON IN WELL 18IN DN @ C/L INT AVE D + 140TH ST W MKD (SEC COR 16 17 20 21 T8N R14W) N EDGE	BL 1226
LIEBRE (1973)	2577.188	RDBM MON 6FT E PP NO 1218924E 45FT N C/L AVE D + 153FT W C/L 140TH ST W (DIRT RD) 2IN IP WITNESS 3FT UP 2FT N	BL 1227
LIEBRE (1973)	2592.986	CS MON (N EDGE) IN WELL 24IN DN @ C/L INT AVE D + 145TH ST W MKD (1/4 COR 17 20 T8N R14W)	BL 1228
LIEBRE (1973)	2595.114	RDBM MON 6FT E PP NO 1218936E 45FT N C/L AVE D + 185FT W C/L 145TH ST W (PROP DIRT RD TO S) 2IN IP WITNESS 3FT UP 2FT N	BL 1229
LIEBRE (1973)	2611.190	RDBM MON 6FT E PP NO 121958E 40FT N C/L AVE D + 190FT E C/L 150TH ST W (PROP DIRT RD) 2IN IP WITNESS 3FT UP 2FT N	BL 1230
LIEBRE (1973)	2613.062	CS MON IN WELL 24IN DN @ C/L INT AVE D + 150TH ST W PROPOSED MKD SEC COR 17 18 19 20 T8N R14W USE W EDGE	BL 1231

QUAD-YEAR	ELEV	DESCRIPTION (INCLUDE QUAD AND YEAR IN DESCRIPTION)	BM NUMBER
LIEBRE (1973)	2625.555	RDBM MON 6FT W PP NO 1219158E 40FT N C/L AVE D + 118FT E C/L 155TH ST W (PROP DIRT RD) 2IN IP WITNESS 3FT UP 2FT N	BL 1232
LIEBRE (1973)	2625.924	CS MON IN WELL 18IN DN @ C/L INT AVE D + 155TH ST W MKD (1/4 COR 18 19 T8N R14W) USS SW EDGE	BL 1233
LIEBRE (1973)	2645.278	CS MON IN WELL 16IN DN @ C/L INT AVE D + 160TH ST W DIRT RD 2IN IP 3FT UP 2FT N	BL 1234
LIEBRE (1973)	2647.056	RDBM MON 6FT E PP NO 1312422E 28FT N C/L AVE D + 160FT W C/L 160TH ST W (DIRT RD) 2IN IP WITNESS 3FT UP 2FT N	BL 1235
LIEBRE (1973)	2665.197	CS MON 26IN DN @ C/L INT AVE D + 165TH ST W MKD (1/4 COR 13 24 T8N R15W) USE N EDGE	BL 1236
LIEBRE (1973)	2667.897	RDBM MON 6FT E PP NO 1312410E 28FT N C/L AVE D + 170FT W C/L 165TH ST W (PROP BUT UNIMPROVED) 2IN IP WITNESS 3FT UP 2FT N	BL 1237
LIEBRE (1973)	2687.547	RDBM MON 6FT E PP NO 1312399E 26FT N C/L AVE D + 73FT E C/L 170TH ST W (DIRT RD) 2IN IP WITNESS 3FT UP 2FT N	BL 1238
LIEBRE (1973)	2687.186	CS MON IN WELL 20IN DN @ C/L INT AVE D + 170TH ST W MKD T8N R15W SEC COR 14 13 23 24	BL 1239
LIEBRE (1973)	2711.632	CS MON 24IN DN @ C/L INT AVE D + 175TH ST W (PROP) MKD (T8N R15W 1/4 SEC COR 14,23) W EDGE	BL 1240
LIEBRE (1973)	2712.825	RDBM MON IN WELL W/COVER 6FT E PP NO 1312386E 45FT N C/L AVE D + 170FT W C/L 175TH ST W (PROP) 2IN IP WITNESS 3FT UP 2FT N	BL 1241
LIEBRE (1973)	2731.907	RDBM MON IN WELL W/COVER 8FT E PP NO 1312375E 45FT N C/L AVE D + 48FT E C/L 180TH ST W (PROP) 2IN IP WITNESS 3FT UP 2FT N	BL 1242
LIEBRE (1973)	2731.913	CS MON 18IN DN @ C/L INT AVE D + 180TH ST W (PROP)(E EDGE)	BL 1243
LIEBRE (1973)	2752.203	RDBM MON IN WELL W/COVER 8FT W PP NO 1312364E 45FT N C/L AVE D + 220FT E 185TH ST W (PROP) 80FT E WEEVIL INN CAFE 2IN IP WITNESS 3FT UP 2FT N	BL 1244
LIEBRE (1973)	2755.041	RDBM TAG @ N EDGE CONC ISL OF GAS PUMP 8FT E OF W END OF ISL 75FT S C/L AVE D + 100FT E C/L 185TH ST W (PROP)	BL 1245
LIEBRE (1973)	2773.449	RDBM MON IN WELL W/COVER 8FT E PP NO 1312350E 45FT N C/L AVE D + 190FT W C/L 190TH ST W 2IN IP MKR 3FT UP 2FT N	BL 1247
LIEBRE (1973)	2787.980	CS MON IN WELL 18IN DN @ C/L INT AVE D + 195TH ST W MKD (1/4 COR 16 21 T8N R15W)(E EDGE)	BL 1248
LIEBRE (1973)	2788.703	RDBM MON IN WELL W/COVER 6FT E PP NO 1312339E 45FT N C/L AVE D + 120FT W C/L 195TH ST W (PROP) 2IN IP WITNESS 3FT UP 2FT N	BL 1249
LIEBRE (1973)	2801.360	RDBM MON IN WELL 45FT N C/L AVE D + 185FT W C/L 200TH ST W 6FT E PP 1312327E 2IN IP 3FT UP 2FT N	BL 1251

QUAD-YEAR	ELEV	DESCRIPTION (INCLUDE QUAD AND YEAR IN DESCRIPTION)	BM NUMBER
LIEBRE (1973)	2813.744	RDBM MON IN WELL W/COVER 6FT E PP NO 1312315E 45FT N C/L AVE D + 145FT W C/L 205TH ST W (PROP) 2IN IP WITNESS 3FT UP 2FT N	BL 1253
LIEBRE (1973)	2817.853	RDBM TAG IN CONC FTG CHAIN LINK FENCE POST OF EDISON SUB-STA @ SW PROP COR 50FT N C/L AVE D + 50FT E C/L 210TH ST W (DIRT RD)	BL 1254
LIEBRE (1973)	2817.594	RDBM MON IN WELL W/COVER 7FT E PP NO 1120417E 27FT N C/L AVE D + 185FT W C/L 215TH ST W 2IN IP MKR 3FT UP 2FT N	BL 1258
LIEBRE (1973)	2811.188	RDBM MON IN WELL W/COVER 6FT NE PP NO 1120427E 33FT N C/L AVE D + 60FT W 220TH ST W (PROP) 2IN IP 3FT UP 2FT N	BL 1260
LIEBRE (1973)	2824.475	RDBM MON IN WELL W/COVER 5FT NE PP NO 1120439E 28FT N C/L AVE D + 180FT W C/L 225TH ST W (PROP) 2IN IP WITNESS 3FT UP 2 FT N	BL 1262
LIEBRE (1973)	2849.307	RDBM MON IN WELL 30FT N C/L AVE D + 170FT W C/L 230TH ST W 5FT NE PP 1120450E 2IN IP MKR 3FT UP 2FT N	BL 1264
LIEBRE (1973)	2878.586	CS MON 20IN DN @ C/L INT AVE D + 235TH ST W MKD (1/4 COR 14 23 T8N R16W)(S EDGE)	BL 1265
LIEBRE (1973)	2882.246	RDBM MON IN WELL W/COVER 5FT NE PP NO 1120461E 30FT N C/L AVE D + 180FT W C/L 235TH ST W 2IN IP 3FT UP 2FT N	BL 1266
LIEBRE (1973)	2918.942	CS MON 18IN DN @ C/L INT AVE D + 240TH ST W MKD (15 14 23 22 T8N R16W)(N EDGE)	BL 1267
LIEBRE (1973)	2920.582	RDBM MON IN WELL W/COVER 6FT E OF PP NO 1120472E 28FT N C/L AVE D + 160FT W C/L 240TH ST W 2IN IP 3FT UP 2FT N	BL 1268
LIEBRE (1973)	3014.956	USC+GS MON FLUSH 30FT SW C/L LANCASTER RD + 0.7MI SE AVE D 2FT SE OF WHITE POST MKD (V 305 1935) 2IN IP 3FT UP 0.5FT S	BL 1271
LIEBRE (1973)	3014.463	CSBM MON 6IN UP 50FT SW C/L AVE D-15 (LANCASTER RD) + 0.5MI W 235TH ST W @ CURVE TO NW 18FT S OF S EDGE PROD OF PVMT MKD (BM 102-56 1957)	BL 1272
LIEBRE (1973)	2972.344	CSBM MON 4IN UP 55FT S C/L LANCASTER RD + 575FT W C/L 235TH ST W 25FT E/O TP NO GT8034 MKD BM 102-55 1957	BL 1273
LIEBRE (1973)	2943.429	CSBM MON 6IN UP 30FT N C/L AVE D-15 (LANCASTER RD) + 0.25MI W 224TH ST W @ SE COR OLIVE GROVE MKD BM 102-54 1957 2IN IP 3FT UP 2FT N	BL 1274
LIEBRE (1973)	2884.563	USC+GS MON IN TOP OF 8IN CONC POST FLUSH 30FT N C/L LANCASTER RD + 0.25MI E/O 224TH ST W MKD W 305 1935 2IN IP 3FT UP 1FT S	BL 1275
LIEBRE (1973)	2880.572	CSBM MON 6IN UP 32FT N C/L AVE D-15 (LANCASTER RD) + 0.8MI W/O 210TH ST W MKD BM 102-52 1957 2IN IP 3FT UP 1FT S	BL 1276
LIEBRE (1973)	2897.485	CSBM MON 6IN UP 49FT N C/L LANCASTER RD + 0.20MI W 210TH ST W MKD (BM 102-51 1957) 2IN IP 3FT UP 2FT S	BL 1277

QUAD-YEAR	ELEV	DESCRIPTION (INCLUDE QUAD AND YEAR IN DESCRIPTION)	BM NUMBER
LIEBRE (1973)	2930.528	CSBM MON 6IN UP 50FT SW C/L LANCASTER RD + 1.0MI NW/O AVE E-15 0.3MI SELY 210TH ST W MKD BM 102-50 1957 2IN IP 3FT UP 1FT NE	BL 1278
LIEBRE (1973)	2953.034	USC+GS MON IN TOP OF 8IN CONC POST 14IN UP 30FT SW CTR OF PVMT LANCASTER RD 0.45 MI NW AVE E-15 MKD X-305 1935 2IN IP 3FT UP 1FT NE	BL 1279
LIEBRE (1973)	2953.374	CSBM MON FLUSH 33FT SW C/L PROD LANCASTER RD 67FT SLY C/L EXISTING PVMT + 0.5MI W/O 195TH ST W PROP 13FT NW 2IN IP MKD BM 102-48 1957 2IN IP 3FT UP 1FT N	BL 1280
LIEBRE (1973)	2900.728	CSBM MON IN WELL 8IN DN @ INT AVE E-15 (LANCASTER RD) + 195TH ST W 65FT E FIELD RD TO S + ON W LINE PROD OF LOT COR MKRS TO N MKD (BM 102-47 1957)	BL 1281
LIEBRE (1973)	2871.180	CSBM MON 6IN UP 45FT N C/L EXISTING PVMT OF LANCASTER RD 132FT W C/L PROD 190TH ST W ON NE SIDE OF CURVE 19FT E/O NE GUARD RAIL MKD BM 102-46 1957 2IN IP 3FT UP 1FT N	BL 1282
LIEBRE (1973)	2895.833	CSBM MON 6IN UP 55FT S C/L AVE F-8 (LANCASTER RD) + 81FT E C/L PROD 190TH ST W 27FT E PP 699391E MKD (BM 102-45 1957)	BL 1283
LIEBRE (1973)	2871.982	CSBM MON 4IN UP 51FT S C/L AVE F-8 (LANCASTER RD) + 0.5MI E 190TH ST W @ DIRT DRWY HSE 18350 3FT N PP 699381E MKD (BM 102-44 1957) 2IN IP 3FT UP 2FT N	BL 1284
LIEBRE (1973)	2831.545	CSBM MON 4IN UP 55FT S C/L AVE F-8 (LANCASTER RD) + 15FT W C/L 180TH ST W 3FT N PP 699364E MKD (BM 102-43 1957) SURVEY MKR 3FT UP 1FT N	BL 1285
LIEBRE (1973)	2807.929	CSBM MON 6IN UP 57FT S C/L AVE F-8 (LANCASTER RD) + 0.5MI W 170TH ST W 2FT W PP 699359E MKD (BM 102-42 1957) 2IN IP 3FT UP 2FT N	BL 1286
LIEBRE (1973)	2785.226	CSBM MON 4IN UP 36FT S C/L LANCASTER RD + 6FT E C/L PROD 170TH ST W MKD (BM 102-41 1957) SURVEY MKR 3FT UP 1FT N	BL 1287
LIEBRE (1973)	2784.214	USGS MON ON 3 1/2IN IP 43FT W C/L LANCASTER RD (167TH ST W) @ AVE F-8 2FT S FENCE COR MKD 2786	BL 1288
LIEBRE (1973)	2790.676	CSBM MON FLUSH 1FT ABOVE RD GRADE 25FT NE C/L LANCASTER RD + 0.5MI NW 160TH ST W 31FT SW PP 699340E UNDER BARBED WIRE FENCE MKD (BM 102-39 1957)	BL 1289
LIEBRE (1973)	2782.702	CSBM MON 4IN UP 90FT NE C/L 160TH ST W + 0.4MI N AVE G-8 @ CURVE TO W 29FT E PP 699344E MKD (BM 102-38 1957)	BL 1290
LIEBRE (1973)	2829.056	CSBM MON 6IN UP 34FT N C/L AVE G-8 + 27FT W C/L 160TH ST W MKD (BM 102-37 1957)	BL 1291
LIEBRE (1973)	2748.856	USGS MON 4IN UP 42FT S C/L LANCASTER RD + 2.9MI W MUNZ RANCH RD 12FT W C/L PROD OF DIRT RD TO N @ INT WITH LINE BETWEEN SEC 5 6 T7N R14W MKD (R 39 1929)	BL 1293

QUAD-YEAR	ELEV	DESCRIPTION (INCLUDE QUAD AND YEAR IN DESCRIPTION)	BM NUMBER
LIEBRE (1973)	2679.841	CSBM MON 4IN UP 113FT S C/L LANCASTER RD + 2.4MI W MUNZ RANCH RD ON LEVEL AREA MIDWAY UP A RISE 307FT W OF FENCE COR + 1FT N FENCE MKD (BM 102-34 1957)	BL 1294
LIEBRE (1973)	2623.199	CSBM MON 4IN UP 25FT N C/L LANCASTER RD + 1.7MI W MUNZ RANCH RD @ LINE BETWEEN SEC 4 5 T7N R14W UNDER FENCE 3FT W OF COR MKD (BM 102-33 1957)	BL 1295
LIEBRE (1973)	2604.388	CSBM MON 3IN UP 25FT N C/L LANCASTER RD + 1.0MI W MUNZ RANCH RD NR PI OF CURVE 3FT S FENCE MKD (BM 102-32 1957)	BL 1296
LIEBRE (1973)	2584.962	USC+GS MON FLUSH 4FT BELOW RD GRADE 42FT S C/L LANCASTER RD + 0.7MI W MUNZ RANCH RD 2FT N FENCE MKD (Z 305 1935)	BL 1297
LIEBRE (1973)	2581.542	CSBM MON 4IN UP 46FT S C/L LANCASTER RD + 0.5MI W MUNZ RANCH RD 1FT NE FENCE MKD (BM 102-30 1957)	BL 1298
LIEBRE (1973)	2567.827	CSBM MON FLUSH 27FT N C/L LANCASTER RD + 30FT W C/L MUNZ RANCH RD 0.6FT N FENCE + 4FT E PP 402818E MKD (BM 102-29 1957)	BL 1299
LIEBRE (1973)	2535.342	CSBM MON 4IN UP 44FT N C/L LANCASTER RD @ 120TH ST W 35FT S FENCE COR MKD (BM 102-28 1958)	BL 1300
LIEBRE (1973)	2546.502	CSBM MON FLUSH 25FT N C/L PROD AVE I + 55FT E C/L PROD 120TH ST W 3FT E PP K6408Y MKD (BM 102-27 1957)	BL 1301
LIEBRE (1973)	2519.726	CS MON IN WELL 10IN DN @ C/L INT AVE I + 115TH ST W MKD (1/4 COR 11 14 R14W T7N)	BL 1302
BASELINE (1965)	2497.288	CS MON IN WELL 15IN DN 5FT N C/L INT AVE I + 110TH ST W MKD (SEC COR 11 12 13 14 R14W T7N)	BL 1303
LIEBRE (1973)	2740.441	T+SPK ON E SIDE OF TP NO M12588Y 55FT E C/L 170TH ST W (PROP) 125FT N C/L AVE E (PROP)	BL 1309
LIEBRE (1973)	2755.782	T+SPK IN E SIDE TP NO 12603Y 55FT E C/L 170TH ST W (PROP) + 115FT N C/L AVE E-8 (PROP) 1.5 MI S AVE D	BL 1311
LIEBRE (1973)	2773.720	CS MON 24IN DN @ C/L INT 170TH ST W + AVE F (PROP) 40FT W C/L DIRT RD + 0.5MI N LANCASTER RD MKD(25 26 35 36 T8N R15W)	BL 1313
LIEBRE (1973)	2774.696	T+SPK IN E SIDE TP NO M12619Y 50FT E C/L 170TH ST W (PROP) + 45FT S C/L AVE F (PROP) 0.5MI N LANCASTER RD	BL 1314
LIEBRE (1973)	2586.072	CSBM MON 6IN UP 34FT NW C/L MUNZ RANCH RD + 0.4MI S LANCASTER RD 160FT S DIRT DRWY HSE 45715 1FT W INT 4FT BARBED WIRE FENCES MKD (BM 113-8 1960)	BL 1315
LIEBRE (1973)	2617.694	CSBM MON 6IN UP 2FT BELOW PVMT GRADE 26FT SE C/L MUNZ RANCH RD 0.8MI S LANCASTER RD MKD (BM 113-7 1960) 2IN IP 3FT UP 2FT W	BL 1316
LIEBRE (1973)	2676.832	CSBM MON 6IN UP 32FT N C/L MUNZ RANCH RD + 3.0MI N ELIZABETH LAKE RD 1100 FT NE POWER LINE CROSSING MKD (BM 113-6 1960) 2IN IP 3FT UP 2FT N	BL 1317



QUAD-YEAR	ELEV	DESCRIPTION (INCLUDE QUAD AND YEAR IN DESCRIPTION)	BM NUMBER
LIEBRE (1973)	2804.026	CSBM MON 6IN UP 4FT BELOW PVMT GRADE 30FT S C/L MUNZ RANCH RD + 2.1MI N ELIZABETH LAKE RD MKD BM 113-4 1960	BL 1319
LIEBRE (1973)	3069.167	CSBM MON 6IN UP 33FT N C/L MUNZ RANCH RD + 1.1MI N ELIZABETH LAKE RD 160FT NE TP 29139M + 120FT NW TP 29138M MKD (BM 113-2 1960)	BL 1321
LIEBRE (1973)	3233.422	CSBM MON 6IN UP 27FT E C/L MUNZ RANCH RD 0.55MI N ELIZABETH LAKE RD 2FT E PP 307253E MKD (BM 113-1 1960) 2IN IP 3FT UP 2FT E	BL 1322
LIEBRE (1973)	3296.539	CSBM MON 6IN UP 31FT W C/L E RDWY MUNZ RANCH RD 73FT N C/L ELIZABETH LAKE RD 3FT N PP 29176M MKD (BM 111-32 1960)	BL 1323
LIEBRE (1973)	3279.268	CSBM MON NW END W ROCKWALL @ ENT TO ELIZABETH LAKE RANCH CLUB 15FT W + 17FT S C/L INT ELIZABETH LAKE RD + PEEKABOO RD MKD (PC 23)	BL 1324
LIEBRE (1973)	3286.497	L+BT SPK 1FT FROM N END W HDWL 79FT S + 35FT W C/L INT ELIZABETH LAKE RD + RANCH CLUB RD	BL 1325
BASELINE (1965)	3332.668	CSBM MON 67FT E C/L INT ELIZABETH LAKE RD + JOHNSON RD 15FT S PP 542086E MKD (PC 21)	BL 1327
LIEBRE (1973)	2971.872	CSBM MON 6IN UP 61FT N C/L HWY 138 + 0.45MI W 245TH ST W ON W SIDE DIRT DR HSE 24715 + 10FT NW PP 1120495E MKD (BM 102-59 1957) 2IN IP 3FT UD 1	BL 1479
LIEBRE (1973)	3017.787	CSBM MON 6IN UP 29FT N C/L HWY 138 + 0.9MI W 245TH ST W 6FT W PP 1123606E MKD (BM 102-60 1957) 2IN IP 3FT UP 1FT S	BL 1480
LIEBRE (1973)	3046.368	LAC DEPT WATER + POWER MON ON 3IN IP FLUSH 26FT S C/L LANCASTER RD + 46FT E/O W + P AQUADUCT 0.2MI E/O THREE POINTS RD 61FT NE/O NE COR 5FT 5FT SQUARE CONC BLDG MKD 104A	BL 1481
LIEBRE (1973)	3052.373	CSBM MON 29FT N C/L LANCASTER RD + 0.35MI W/O THREE POINTS RD 6FT W/O PP NO 1123627E + 12FT SE 4FT IRRIGATION STANDPIPE MKD BM 102-62 1957	BL 1482
LIEBRE (1973)	3051.130	CSBM MON 6IN UP 70FT S C/L LANCASTER RD @ CURVE TO N INTO 270TH ST W MKD BM 102-63 1957 2IN IP 2FT UP 1FT N	BL 1483
LIEBRE (1973)	2992.209	USC+GS MON 2IN UP 60FT S C/L LANCASTER RD @ W END CURVE FROM 270TH ST W OPPOSITE HSE NO 27011 22FT SW PP NO 1123656E MKD U305 1935 2IN IP 3FT UP 2FT N	BL 1484
LIEBRE (1973)	3009.129	BT SPK 1FT N/O S END OF HDWL OF CULV 29FT S C/L LANCASTER RD + 0.4MI W/O 270TH ST W MKD 102-65A	BL 1486
LIEBRE (1973)	3037.041	CSBM MON 3IN UP 49FT S C/L LANCASTER RD + 0.2MI E/O METTLER + BURY FARMS @ 280TH ST W 4FT W/O PP NO 1122597E MKD BM 102-66 1957 2IN IP 2FT UP 1FT N	BL 1487
LIEBRE (1973)	3043.281	CSBM MON 2IN UP 49FT S C/L LANCASTER RD + 0.4MI W/O METTLER + BURY FARMS 190FT W C/L INT MARGLO ST (DIRT) 4FT W/O PP NO 1123690E MKD BM 102-67 1957 2IN IP 2FT UP 1FT N	BL 1488

QUAD-YEAR	ELEV	DESCRIPTION (INCLUDE QUAD AND YEAR IN DESCRIPTION)	BM NUMBER
LIEBRE (1973)	3020.540	USC+GS MON 10IN DN 49FT S C/L LANCASTER RD @ DIRT RD TO HSE NO 29300 1.0MI E/O 300TH ST W 19FT E/O FENCE COR 83FT E/O CULV 82FT E/O PP NO 1123700E MKD T 305 1935 2IN IP 3FT UP 1FT N	BL 1489
LIEBRE (1973)	3041.968	CSBM MON 6IN UP 49FT S C/L HWY 138 + 1.3MI W METTLER + BURY FARMS 0.5MI E 300TH ST W 4FT W PP 1123711E + 39FT E OF FENCE LINE PROD MKD (BM 102-69 1957) 2IN IP 3FT UP 1FT N	BL 1490
LIEBRE (1973)	3044.054	CSBM MON 6IN UP 48FT S C/L HWY 138 + 215FT E C/L 300TH ST W OPP HSE 29853 4FT W PP 1123722E + 6FT E FENCE COR MKD (BM 102-70 1957) 2IN IP 3FT UP 1	BL 1491
LIEBRE (1973)	3088.288	CSBM MON 4IN UP 50FT NW C/L HWY 138 + 0.6MI W 300TH ST W 87FT W OF W END HDWL CULV 211+43 10FT N PP 1049047E + 5FT SW FENCE COR MKD (BM 102-71 1957) 2IN IP 3FT UP 1FT S	BL 1492
LIEBRE (1973)	3123.373	CSBM MON 6IN UP 49FT SE C/L HWY 138 + 3.50MI E OLD RIDGE RTE 16FT W CATTLE GATE + 9FT S PP 1049033 MKD (BM 102-72 1957) 2IN IP 3FT UP 1FT N	BL 1493
LIEBRE (1973)	3143.863	CSBM MON 2IN UP 49FT S C/L HWY 138 + 1.6MI W 300TH ST W 20FT S OF S END HDWL CULV 156+09 MKD (BM 102-73 1957) 2IN IP 3FT UP 1FT N	BL 1494
LIEBRE (1973)	3169.335	CSBM MON 6IN UP 48FT S C/L HWY 138 + 2.5MI E OLD RIDGE RTE 18FT S OF S END CULV A133+60 MKD (BM 102-74 1957) 2IN IP 3FT UP 1FT N	BL 1495
LIEBRE (1973)	3209.944	CSBM MON 4IN UP 48FT S C/L LANCASTER RD (HWY 138) 16FT S/O S END CONC HDWL + 1.9MI E/O OLD RIDGE RTE RD MKD BM 102-75 1957 2IN IP 3FT UP 1FT N	BL 1496
LIEBRE (1973)	3270.959	USC+GS MON FLUSH 50FT N C/L HWY 138 + 1.4MI E OLD RIDGE RTE 485FT E CULV 75+78 75FT E PP 1061987E MKD (R 305 1935) 2IN IP 3FT UP 1FT S	BL 1497
LIEBRE (1973)	3339.258	CSBM MON 6IN UP 49FT S C/L HWY 138 + 0.75MI E OLD RIDGE RTE 17FT S OF S END CONC HDWL CULV 51+ 15 MKD (BM 102-77 1957) 2IN IP 3FT UP 1FT N	BL 1498
LIEBRE (1973)	3395.606	CSBM MON 6IN UP 48FT S C/L HWY 138 + 0.4MI E OLD RIDGE RTE 10FT W FENCE COR MKD (BM 102-78 1957)	BL 1499
LIEBRE (1973)	3377.541	BT SPK NR N END S HDWL CULV UNDER HWY 138 ON E SIDE OF INT HWY 138 + OLD RIDGE RTE	BL 1500
LIEBRE (1973)	3335.370	USC+GS MON 5IN UP 37FT S C/L GORMAN POST RD @ INT W/DIRT RD TO S 25FT W/O SW COR OF CATTLE GUARD 6FT N/O PP NO 1699201E 0.2MI W/O INT OF LANCASTER RD MKD Q 452 1953 MKR POST 1.7FT W	BL 1506
LIEBRE (1973)	3382.988	USC+GS MON 9IN UP 94FT SE C/L GORMAN POST RD (HWY 138) 0.4MI W/O LANCASTER RD ON SW SIDE OF SMALL HILL 9FT SW/O PP NO 1707769E MKD Z 531926 RESET 1953 MKR POST 2FT W	BL 1507
LIEBRE (1973)	3398.985	USC+GS MON 4FT W/O E END N HDWL OF CULV NO 0.60 21FT N C/L GORMAN POST RD + 0.5MI W/O LANCASTER RD MKD P 452 1953	BL 1508

QUAD-YEAR	ELEV	DESCRIPTION (INCLUDE QUAD AND YEAR IN DESCRIPTION)	BM NUMBER
LIEBRE (1973)	3585.109	USC+GS MON 5IN UP 48FT NE C/L GORMAN POST RD + 1.2MI W/O LANCASTER RD 24FT S C/L DIRT RD TO E MKD B 370 1953 MKR POST 1.8FT NW	BL 1510
LIEBRE (1973)	3562.645	USC+GS MON 6IN UP 82FT N C/L GORMAN POST RD + 1.3MI W/O LANCASTER RD @ W END OF CUT 25FT NW C/L DIRT RD TO NE MKD M452 1953 MKR POST 1.4FT W	BL 1511
LIEBRE (1973)	3482.100	USC+GS MON 1FT W/O E END S HDWL OF CULV NO 1.80 28FT S C/L GORMAN POST RD 1.65MI W/O LANCASTER RD MKD 1 452 1953	BL 1512
LIEBRE (1973)	3458.899	USC+GS MON 4IN UP 41FT S C/L GORMAN POST RD + 1.9MI W/O LANCASTER RD 30FT SW OF S END OF CULV NO 2.00 MKD A 370 1953 MKR POST 1.5FT W	BL 1513
LIEBRE (1973)	3481.746	USC+GS MON 6IN UP 42FT SW C/L GORMAN POST RD + 2.1MI W/O LANCASTER RD NR POWER LINE CROSSING 50FT W/O NW END SW HDWL OF CULV NO 2.20 MKD K 452 1953 MKR POST 1.5FT NW	BL 1514
LIEBRE (1973)	3485.466	USC+GS MON 5IN UP 31FT SW C/L GORMAN POST RD + 2.5MI W/O LANCASTER RD 47FT W/O TP NO 25-41 MKD J 452 1953 MKR POST 1.3FT W	BL 1515
LIEBRE (1973)	3512.943	USC+GS MON 5IN UP 36FT SW C/L GORMAN POST RD + 2.8MI W/O LANCASTER RD 68FT SE OF E END OF S HDWL OF CULV NO 2.90 15FT W/O TP NO 15-41 MKD A 54 1926 MKR POST 1.4FT E	BL 1516
LIEBRE (1973)	3558.487	USC+GS MON 5IN UP 39FT NE C/L GORMAN POST RD + 3.25MI W/O LANCASTER RD 79FT SE /O PP NO 1061807 MKD G 452 1953 MKR POST 1.7FT SE	BL 1518
LIEBRE (1973)	3600.028	USC+GS MON 5IN UP 50FT N/O C/L GORMAN POST RD + 1.6MI E/O GORMAN SCHOOL RD 2FT W/O SE COR FENCE AROUND EDISON GORMAN SUB-STA 42FT NE/O PP NO 800607E MKD F 452 1953 MKR POST 1.7FT W	BL 1519
LIEBRE (1973)	3631.393	USC+GS MON @ E END OF N HDWL OF CULV NO 4.00 22FT N C/L GORMAN POST RD + 1/3MI E/O GORMAN SCHOOL RD MKD R 608 1942	BL 1520
BASELINE (1965)	3057.643	USGS MON @ SE COR JOHNSON RD + DIRT RD TO FOOTHILL RANCH 105FT S APPROX C/L + 2.5MI E ELIZABETH LAKE RD MKD (R 43 1929)	BL 2066C
BASELINE (1965)	3192.726	RDBM TAG CONC + ROCK HDWL 11.79 15FT N APPROX C/L JOHNSON RD + 2.1MI E ELIZABETH LAKE RD	BL 2067C
BASELINE (1965)	3194.138	CSBM MON 6IN UP 28FT N APPROX C/L JOHNSON RD + 2.1MI E ELIZABETH LAKE RD 22FT NE CULV 11.79 MKD (BM 119-31 1961)	BL 2068C
BASELINE (1965)	3347.286	CSBM MON 6IN UP 35FT N APPROX C/L JOHNSON RD + 1.6MI E ELIZABETH LAKE RD 31FT NE CULV 12.25 MKD (BM 119-32 1961)	BL 2069C
BASELINE (1965)	3407.948	RDBM TAG CONC + ROCK HDWL 12.39 25FT N APPROX C/L JOHNSON RD + 1.5MI E ELIZABETH LAKE RD	BL 2070C
BASELINE (1965)	3438.440	CS MON 6IN UP 200FT N APPROX C/L JOHNSON RD + 1.5MI E ELIZABETH LAKE RD MKD (1/4 COR 27 34 T7N R14W)	BL 2071C

QUAD-YEAR	ELEV	DESCRIPTION (INCLUDE QUAD AND YEAR IN DESCRIPTION)	BM NUMBER
BASLINE (1965)	3522.644	CSBM MON 6IN UP 31FT S APPROX C/L JOHNSON RD + 1.25 MI E ELIZABETH LAKE RD @ SUMMIT MKD (BM 119-33 1961)	BL 2072C
BASLINE (1965)	3455.229	CS MON 1IN DN 55FT S APPROX C/L JOHNSON RD + 1.0MI E ELIZABETH LAKE RD MKD (SEC COR 28 27 33 34 T7N R14W) USS N EDGE	BL 2073C
BASLINE (1965)	3476.549	CSBM MON 6IN UP 38FT S APPROX C/L JOHNSON RD + 0.75MI E ELIZABETH LAKE RD NR E SIDE OF ENT LEONA VALLEY HUNTING CLUB MKD (BM 119-34 1961)	BL 2075C
BASLINE (1965)	3414.952	CS MON FLUSH 100FT S APPROX C/L JOHNSON RD + 0.5MI E ELIZABETH LAKE RD MKD (1/4 COR 28 33 R14W T7N)	BL 2076C
BASLINE (1965)	3407.982	L+DATE SPK SE CONC BASE TOWER 220/6 140FT N APPROX C/L JOHNSON RD + 0.4MI E ELIZABETH LAKE RD	BL 2077C
BASLINE (1965)	3395.161	CSBM MON 6IN UP 28FT N APPROX C/L JOHNSON RD + 0.3MI E ELIZABETH LAKE RD MKD (BM 119-35 1961)	BL 2078C
LIEBRE (1973)	2534.466	CS MON 14IN DN @ C/L INT 120TH ST W + FUT AVE H-8 MKD (1/4 COR 10 11 R14W T7N)	BL 2092
LIEBRE (1973)	3293.059	CS MON 2IN UP 50FT N C/L ELIZABETH LAKE RD + 105FT W OF E RDWY MUNZ RANCH RD MKD (PC 24)	BL 2093
LIEBRE (1973)	2881.448	USC+GS MON FLUSH 36FT N CTR PVMT AVE F-8 (LANCASTER RD) + 0.3MI W FUT 185TH ST W MKD (Y 305 1935) SURVEY MKR 2FT UP 1FT N	BL 2114
LIEBRE (1973)	2812.196	CS MON IN WELL 22IN DN @ C/L INT AVE D + FUT 220TH ST W MKD (T8N R15W SEC COR 13 18 19 24) USE N EDGE	BL 2116
LIEBRE (1973)	2817.146	CS MON IN WELL 20IN DN @ C/L INT AVE D + 215TH ST W MKD (T8N R15W 1/4 SEC COR 18 19) USE N EDGE	BL 2117
LIEBRE (1973)	2817.303	CS MON IN WELL 24IN DN @ C/L INT AVE D + 210TH ST W MKD (T8N R15W SEC COR 18 17 20 19) SE EDGE	BL 2118
LIEBRE (1973)	2812.504	CS MON IN WELL 28IN DN @ C/L INT AVE D + 205TH ST W MKD (T8N R15W 1/4 SEC COR 17 20) USE S EDGE	BL 2119
LIEBRE (1973)	2801.178	CS MON IN WELL 26IN DN @ C/L INT AVE D + FUT 200TH ST W MKD (T8N R15W SEC COR 17 16 21 20) USE S EDGE	BL 2120
LIEBRE (1973)	2772.317	CS MON IN WELL 24IN DN @ C/L INT AVE D + 190TH ST W MKD (T8N R15W SEC COR 16 15 21 22) S EDGE	BL 2121
LIEBRE (1973)	2734.971	CSBM MON 30FT N C/L AVE D 215FT W C/L 180TH ST W 40FT W PP 1312374E MKD (BM 117-40 1961) 2IN IP MKR 2FT E	BL 2123
LIEBRE (1973)	2713.873	CSBM MON (S SIDE) 15FT W + 30FT N C/L INT 175TH ST W + AVE D MKD (BM 117-39 1961) 2IN IP MKR 3FT UP 2FT S	BL 2124
LIEBRE (1973)	2563.265	CS MON @ C/L INT 135TH ST W + AVE D MKD (1/4 COR 16 21 T8N R14W)	BL 2126

QUAD-YEAR	ELEV	DESCRIPTION (INCLUDE QUAD AND YEAR IN DESCRIPTION)	BM NUMBER
LIEBRE (1973)	2527.908	USC+GS MON 6IN UP 45FT N + 8FT E C/L INT AVE D + 125TH ST W MKD (WIND 1952) 2IN IP 3FT UP 4FT E	BL 2127
BASLINE (1965)	2488.933	CSBM MON 72FT S + 32FT E C/L INT AVE D-8 + 110TH ST W MKD (BM 119-42 1961)	BL 2131
BASLINE (1965)	2481.336	CS MON (NE EDGE) IN WELL 18IN DN @ C/L INT 110TH ST W + AVE E MKD (SEC COR 23 24 25 26 R14W T8N)	BL 2132
BASLINE (1965)	2485.210	CSBM MON 6IN UP 117FT S + 30FT W C/L INT 110TH ST W + FUT AVE E MKD (BM 119-43 1961)	BL 2133
BASLINE (1965)	2494.208	CS MON IN WELL 18IN DN @ C/L INT 110TH ST W + FUT AVE E-8 30FT E PP 1222609E MKD (1/4 COR 25 26 R14W T8N)	BL 2134
BASLINE (1965)	2496.326	CSBM MON 6IN UP 110FT S + 30FT W C/L INT 110TH ST W + AVE E-8 110FT S PP 1222609E MKD (BM 119-44 1961)	BL 2135
BASLINE (1965)	2513.327	CS MON (NE EDGE) IN WELL 18IN DN @ C/L INT 110TH ST W + AVE F 25FT S + 30FT E PP 1222594E MKD (SEC COR 26 25 35 36 R14W T8N)	BL 2136
BASLINE (1965)	2516.157	CSBM MON 6IN UP 260FT S + 35FT W C/L INT 110TH ST W + FUT AVE F MKD (BM 119-45 1961)	BL 2137
BASLINE (1965)	2514.840	CS TRI STA MON 8IN UP 238FT S + 38FT W C/L INT AVE F + 110TH ST W MKD (DEL SUR G-1 ECC 1 1964)	BL 2138A
BASLINE (1965)	2487.868	CS MON (N EDGE) IN WELL 16IN DN @ C/L INT 110TH ST W + AVE F-8 MKD (1/4 COR 35 36 R14W T8N)	BL 2139
BASLINE (1965)	2490.818	CSBM MON 6IN UP 240FT S + 30FT W C/L INT 110TH ST W + AVE F-8 92FT N PP 1222581E MKD (BM 119-46 1961)	BL 2140
BASLINE (1965)	2493.045	CS MON (N EDGE) IN WELL 12IN DN @ C/L INT 110TH ST W + AVE G MKD (SEC COR 35 36 1 2 R14W T7N T8N)	BL 2141
BASLINE (1965)	2496.752	CSBM MON 6IN UP 30FT S + 30FT W C/L INT 110TH ST W + AVE G MKD (BM 119-40 1961)	BL 2142
BASLINE (1965)	2494.393	CS MON (W EDGE) IN WELL 12IN DN @ C/L INT 110TH ST W + AVE G-8 MKD (1/4 COR 1 2 R14W T7N)	BL 2143
BASLINE (1965)	2499.049	CSBM MON 35FT W C/L 110TH ST W + 365FT S AVE G-8 MKD (BM 119-21 1961)	BL 2144
BASLINE (1965)	2494.635	CS MON (E EDGE) IN WELL 24IN DN @ C/L INT 110TH ST W + AVE H MKD (SEC COR 1 2 11 12 T7N R14W)	BL 2145A
BASLINE (1965)	2497.882	CSBM MON 160FT S + 30FT W C/L INT 110TH ST W + AVE H MKD (BM 119-22 1961)	BL 2146
BASLINE (1965)	2500.044	CS MON (E EDGE) IN WELL 12IN DN @ C/L INT 110TH ST W + AVE H-8 MKD (1/4 COR 11 12 T7N R14W)	BL 2147
BASLINE (1965)	2501.568	CSBM MON 30FT E C/L 110TH ST W 390FT S AVE H-8 MKD (BM 119-23 1961)	BL 2148
BASLINE (1965)	2504.644	CS MON (W EDGE) IN WELL @ C/L INT 110TH ST W + AVE I-8 MKD (1/4 COR 13 14 T7N R14W)	BL 2149A

**OUT**

**OUT**

**DISTURBED**

QUAD-YEAR	ELEV	DESCRIPTION (INCLUDE QUAD AND YEAR IN DESCRIPTION)	BM NUMBER
BASELINE (1965)	2505.583	CSBM MON 6IN UP 30FT W C/L 110TH ST W + 260FT S AVE I-8 174FT SW TP 49/30 MKD (BM 119-24 1961)	BL 2150
BASELINE (1965)	2535.556	USC+GS TRI STA MON FLUSH ON SW COR AVE J + 110TH ST W 45FT W + 40FT S C/L INT MKD (SUR 1932)	BL 2152
BASELINE (1965)	2581.374	CS MON (N EDGE) IN WELL @ C/L INT 110TH ST W + AVE J-8 (DIRT RD TO W) MKD (1/4 COR 23 24 R14W T7N)	BL 2154
BASELINE (1965)	2674.611	CS MON (E EDGE) IN WELL @ C/L INT AVE K + 110TH ST W MKD (SEC COR 23 24 26 25 T7N R14W)	BL 2156A
BASELINE (1965)	2681.649	CSBM MON 6IN UP ON SW COR AVE K + 110TH ST W 82FT S + 27FT W C/L INT MKD (BM 119-27 1961)	BL 2157
LIEBRE (1973)	2900.963	USC+GS MON 42FT S C/L JOHNSON RD 0.95MI SW INT 110TH ST W + AVE K 64FT W + 52FT S/O PP NO 1897436E MKD V 1044 1960	BL 2159
LIEBRE (1973)	2855.263	CS MON IN WELL 14IN DN @ C/L INT AVE D-8 + 210TH ST W MKD (1/4 COR 19 20 R15W T8N)	BL 2201
LIEBRE (1973)	3049.168	CSBM MON 4IN UP ON SE COR LANCASTER RD + THREE POINTS RD 90FT S + 20FT E C/L INT MKD (BM 111- 62 1960) 2IN IP 3FT UP 2FT W	BL 2285
LIEBRE (1973)	3305.153	CSBM MON FLUSH 34FT N C/L ELIZABETH LAKE RD + 0.5MI W MUNZ RANCH RD 10FT N PP 1184025E + 100FT E ENT TO ANGELES NATIONAL FOREST MKD (BM 111-33 1960)	BL 2306
LIEBRE (1973)	3304.213	USC+GS MON FLUSH 30FT S C/L ELIZABETH LAKE RD NR ENT TO EDGEWATER PARK 0.65MI W MUNZ RANCH RD (W FORK) 16FT E CULV 18.13 BET LIGHT POLE + SURVEY MARKER SIGN MKD (T 975 1964)	BL 2307
LIEBRE (1973)	3295.488	USGS MON 4IN UP 123FT S C/L ELIZABETH LAKE RD + 1.75MI E MOUNTAIN VIEW RD MKD (K 19 1929) 2IN MKR PIPE 2FT N	BL 2308
LIEBRE (1973)	3287.405	CSBM MON 6IN UP 29FT N C/L ELIZABETH LAKE RD + 1.5MI W MUNZ RANCH RD 7FT N FIRE DEPT TP 111-51 MKD (BM 111-35 1960)	BL 2309
LIEBRE (1973)	3289.396	USC+GS MON 4IN UP @ NE COR ELIZABETH LAKE RD + ENT TO UNION SCHOOL 75FT N + 20FT E APPROX C/L INT 0.9MI E MOUNTAIN VIEW RD MKD (S 975 1964)	BL 2310
LIEBRE (1973)	3278.155	CS MON 4IN UP 220FT N C/L ELIZABETH LAKE RD @ FIRE DEPT PINE CYN STA 18FT NE OF NW COR FIRE ENGINE GARAGE 0.5MI E MOUNTAIN VIEW RD MKD (23 24 25 26 T7N R15W 1928)	BL 2311
LIEBRE (1973)	3249.065	USGS MON 6IN UP 66FT N C/L ELIZABETH LAKE RD + 30FT E C/L LAKE HUGHES RD MKD (R23 1929) 2IN IP MKR 2FT N	BL 2314
BASELINE (1965)	2485.685	CSBM MON 4IN UP ON SE COR AVE A + 110TH ST W 28FT S + 75FT E C/L INT MKD (BM 117-20 1961) 2IN IP 3FT UP 2FT N	BL 2325C
BASELINE (1965)	2484.059	CS MON IN WELL 14IN DN @ C/L INT AVE A + 110TH ST W MKD (35 36 2 1 R14W T8N T9N) USE S EDGE	BL 2326C

QUAD-YEAR	ELEV	DESCRIPTION (INCLUDE QUAD AND YEAR IN DESCRIPTION)	BM NUMBER
BASELINE (1965)	2486.956	CSBM MON 6IN UP 300FT N + 30FT W C/L INT AVE A-8 + 110TH ST W MKD (BM 119-36 1961) 2IN IP 3FT UP 2FT E	BL 2327C
BASELINE (1965)	2485.879	CS MON IN WELL 14IN DN @ C/L INT AVE A-8 + 110TH ST W MKD (1/4 COR 2 1 T8N R14W) USE E EDGE	BL 2328C
BASELINE (1965)	2482.729	CS MON IN WELL 30IN DN @ C/L INT AVE B + 110TH ST W MKD (2 1 11 12 R14W T8N) USE E EDGE	BL 2329C
BASELINE (1965)	2484.997	CSBM MON 4IN UP ON NE COR AVE B + 110TH ST W 28FT N + 55FT E C/L INT MKD (BM 119-37 1961) 2IN IP 3FT UP 2FT S	BL 2330C
BASELINE (1965)	2484.179	CS MON IN WELL 20IN DN @ C/L INT 110TH ST W + FUT AVE B-8 MKD (1/4 COR 11 12 R14W T8N)	BL 2331C
BASELINE (1965)	2486.474	CSBM MON 4IN UP @ SE COR 110TH ST W + FUT AVE B-8 125FT S + 28FT E C/L INT MKD (BM 119-38 1961) 2IN IP 3FT UP 2FT W	BL 2332C
BASELINE (1965)	2483.384	CS MON IN WELL 16IN DN @ C/L INT 110TH ST W + AVE C MKD (11 12 13 14 R14W T8N) USE NE EDGE	BL 2333C
BASELINE (1965)	2486.100	CSBM MON 4IN UP @ SE COR 110TH ST W + AVE C 85FT S + 27FT E C/L INT MKD (BM 119-39 1961) 2IN IP 3FT UP 2FT W	BL 2334C
BASELINE (1965)	2482.611	CS MON IN WELL 14IN DN @ C/L INT 110TH ST W + AVE C-8 MKD (1/4 COR 14 13 T8N R14W) USE NE COR	BL 2335C
BASELINE (1965)	2485.571	CSBM MON 6IN UP ON SW COR 110TH ST W + AVE C-8 95FT S + 25FT W C/L INT MKD (BM 119-40 1961) 2IN IP 3FT UP 2FT E	BL 2336C
LIEBRE (1973)	3816.655	L + T IN CONC HDWL 58FT S + 60FT W C/L INT PEACE VALLEY RD + GORMAN SCHOOL RD 500FT S/O GOLDEN STATE FRWY OVERPASS	BL 2871
LIEBRE (1973)	3843.093	L+BN W END CONC HDWL 55FT S C/L PEACE VALLEY RD 0.15MI W GORMAN SCHOOL RD NR MKR NO 3.50MKD (BM)	BL 2872
LIEBRE (1973)	3840.846	L+BN W END CONC HDWL 45FT N C/L PEACE VALLEY RD 0.15MI W GORMAN SCHOOL RD NR MKR NO 3.50MKD (BM)	BL 2873
LIEBRE (1973)	3906.441	L + BN 5FT W/O E END OF CONC HDWL 40FT S C/L PEACE VALLEY RD + 0.45MI W/O GORMAN SCHOOL RD NR RD MKR NO 3.20 MKD BM	BL 2874
LIEBRE (1973)	3925.265	L + BN IN CONC HDWL 50FT S C/L PEACE VALLEY RD + 0.6MI W/O GORMAN SCHOOL RD NR RD MKR NO 3.00 35FT W/O MAC DR TO CIRCLE R RANCH	BL 2875
LIEBRE (1973)	3962.271	L+BN CTR CONC HDWL 55FT S C/L PEACE VALLEY RD 0.75MI W GORMAN SCHOOL RD NR MKR NO 2.70MKD (BM)	BL 2876
LIEBRE (1973)	2501.115	CS MON (S EDGE) IN WELL 10IN DN @ C/L INT AVE D + 115TH ST W MKD (1/4 COR 14 23 T8N R14W)	BL 3370
LIEBRE (1973)	2709.853	CS MON 24IN DN @ C/L INT 170TH ST W + PROP AVE D-8 MKD (1/4 COR 23 24 T8N R15W) 2IN IP 3FT UP 2FT N	BL 3371

QUAD-YEAR	ELEV	DESCRIPTION (INCLUDE QUAD AND YEAR IN DESCRIPTION)	BM NUMBER
LIEBRE (1973)	2734.628	CS MON 15IN DN @ C/L INT 170TH ST W + PROP AVE E MKD (SEC COR 23 24 25 26 T8N R15W) 2IN IP 3FT UP 2FT N	BL 3372
LIEBRE (1973)	2786.396	CS MON FLUSH ON C/L PROD 170TH ST W 120FT S C/L LANCASTER RD MKD (1/4 COR 35 36 T8N R15W) 2IN IP 3FT UP 2FT NE	BL 3373
LIEBRE (1973)	2770.317	CSBM MON FLUSH 35FT S C/L LANCASTER RD + 0.5MI E 160TH ST W MKD (BM 102-36A 1967) 2IN IP 3FT UP 3FT NE	BL 3374
LIEBRE (1973)	2773.120	CSBM MON 6IN UP ON SE COR AVE D + 190TH ST W 86FT S + 32FT E C/L INT MKD (BM 117-42 1961) 2IN IP 3FT UP 2FT W	BL 3375
LIEBRE (1973)	2721.335	X IN S EDGE 2IN IP 5IN UP ON SE COR 190TH ST W + PROP AVE C 30FT S + 30FT E C/L INT	BL 3378
LIEBRE (1973)	2696.924	X IN E EDGE 2IN IP 2IN UP ON SE COR 190TH ST W + AVE B-8 30FT S + 30FT E C/L INT	BL 3380
LIEBRE (1973)	2669.719	CS MON 2IN DN @ C/L INT 190TH ST W + AVE B MKD (SEC COR 4 3 9 10 T8N R15W) USE S EDGE	BL 3382
LIEBRE (1973)	2661.078	U S GEN LAND OFFICE MON 3IN UP @ C/L INT (AVE A + 190TH ST W MKD (33 34 4 3 T8N T9N R15W)	BL 3387
LIEBRE (1973)	2648.709	CS MON @ C/L INT AVE A + 185TH ST W MKD (34 3 T8N T9N R15W)	BL 3388
LIEBRE (1973)	2641.849	U S GEN LAND OFFICE MON 2IN UP @ C/L INT 180TH ST W + AVE A MKD (34 35 3 2 T8N T9N R15W)	BL 3389
LIEBRE (1973)	2627.060	RDBM TAG CONC FOOTING OF 6FT WIRE FENCE 17FT S C/L AVE A + 40FT W C/L PROP 175TH ST W	BL 3391
LIEBRE (1973)	2614.615	CSBM MON 6IN UP ON SE COR 170TH ST W + AVE A 90FT E + 38FT S C/L INT MKD (BM 117-32 1961) 2IN IP 3FT UP 2FT N	BL 3392
LIEBRE (1973)	2496.082	CSBM MON 6IN DN ON SE COR AVE A + FUT 115TH ST W 7FT E + 30FT S C/L INT MKD (BM 117-21 1961) 2IN IP 3FT UP 2FT N	BL 3541
LIEBRE (1973)	2509.787	CSBM MON FLUSH ON SW COR AVE A + FUT 120TH ST W 30FT S + 50FT W C/L INT MKD (BM 117-22 1961) 2IN IP 3FT UP 2FT N	BL 3542
LIEBRE (1973)	2522.512	CSBM MON FLUSH ON SW COR AVE A + FUT 125TH ST W 30FT S + 80FT W C/L INT MKD (BM 117-23 1961) 2IN IP 2FT UP 2FT N USE N EDGE	BL 3543
LIEBRE (1973)	2537.625	CSBM MON 6IN UP ON SW COR AVE A + 130TH ST W 70FT S + 30FT W C/L INT MKD (BM 117-24 1961) 2IN IP 3FT UP 2FT E	BL 3544
LIEBRE (1973)	2546.581	CS MON IN WELL 11IN DN @ C/L INT AVE A + FUT 135TH ST W MKD (1/4 COR 33 4 R14W T8N T9N) USE SE COR	BL 3545
LIEBRE (1973)	2563.761	CSBM MON 6IN UP ON SW COR AVE A + 140TH ST W 40FT S + 41FT W C/L INT MKD (BM 117-26 1961) 2IN IP 3FT UP 2FT N	BL 3546



QUAD-YEAR	ELEV	DESCRIPTION (INCLUDE QUAD AND YEAR IN DESCRIPTION)	BM NUMBER
LIEBRE (1973)	2573.582	CSBM MON FLUSH ON SW COR AVE A + FUT 145TH ST W 30FT S + 70FT W C/L INT MKD (BM 117-27 1961) 2IN IP 3FT UP 2FT N	BL 3547
LIEBRE (1973)	2584.282	CS MON IN WELL 14IN DN @ C/L INT AVE A + FUT 150TH ST W MKD (SEC COR 5 6 32 31 R14W T8N T9N) USE E EDGE	BL 3548
LIEBRE (1973)	2594.386	CSBM MON 3IN UP ON SW COR AVE A + FUT 155TH ST W 42FT S + 40FT W C/L INT MKD (BM 117-29 1961) 2IN IP 3FT UP 2FT N	BL 3549
LIEBRE (1973)	2605.022	CSBM MON 6IN UP ON SW COR FUT 160TH ST W + AVE A 40FT S + 50FT W C/L INT MKD (BM 117-30 1961) 2IN IP 3FT UP 2FT N	BL 3550
LIEBRE (1973)	2609.865	CSBM MON 6IN UP ON SE COR FUT 165TH ST W + AVE A 40FT S + 50FT E C/L INT MKD (BM 117-31 1961) 2IN IP 3FT UP 2FT N	BL 3552
LIEBRE (1973)	2622.387	CS MON IN WELL 8IN DN @ C/L INT 170TH ST W + AVE B MKD (1 2 11 12 T8N R15W) USE NW EDGE	BL 3554
LIEBRE (1973)	2642.118	CS MON IN WELL 15IN DN @ C/L INT 170TH ST W + FUTURE AVE B-8 MKD 1/4 COR 11 12 R15W T8N S EDG	BL 3555
LIEBRE (1973)	2663.869	CS MON 15IN DN @ C/L INT 170TH ST W + FUT AVE C MKD (11 12 13 14 T8N R15W) USE E EDGE	BL 3556
LIEBRE (1973)	2681.734	CSBM MON FLUSH ON SE COR 170TH ST W + FUT AVE C-8 51FT E + 98FT S C/L INT MKD (BM 117-37 1961) 2IN IP 3FT UP 2FT W	BL 3557
LIEBRE (1973)	2798.360	CSBM MON 6IN UP 29FT E C/L 190TH ST W + 0.5MI S AVE D MKD (BM 117-43 1961) 2IN IP 3FT UP 2FT W	BL 3558
LIEBRE (1973)	2850.315	CSBM MON 6IN UP ON SW COR 190TH ST W + AVE E-8 126FT W + 48FT S C/L INT MKD (BM 117-45 1961) 2IN IP 3FT UP 2FT E	BL 3560
BASELINE (1965)	2583.807	LACS BM MON 6IN UP 34FT E C/L 110TH ST W + 2FT N C/L FUT AVE J-8 MKD BM 119-26 1961 2IN IP 3FT UP 2FT SW	BL 3632
BASELINE (1965)	2537.064	USC+GS REF MON 2IN UP 41FT S + 107FT W C/L INT 110TH ST W + AVE J MKD SUR 2 NO 5 1968	BL 3635
BASELINE (1965)	2487.638	CSBM 6IN UP 87FT S/O C/L AVE D + 30FT W/O C/L 110TH ST W MKD BM 119-41 1961 2IN IP 3FT UP 2FT E	BL 3636C
LIEBRE (1973)	2495.803	CS MON IN WELL 8IN DN @ C/L INT AVE A + FUTURE 115TH ST W MKD 1/4 COR 35 2 T6N T9N R14W USE W EDGE	BL 3994
LIEBRE (1973)	2511.069	RDBM TAG IN NW CORC FOOTING OF TRANSMISSION TOWER NO 41-1 51FT E C/L FUTURE 120TH ST W + 66FT S C/L AVE A	BL 3995
LIEBRE (1973)	2522.204	1.5IN IP W/CONC PLUG + BR FLUSH 50FT W + 50FT S C/L INT AVE A + FUTURE 125TH ST W 12FT S/O PP NO 1559540E	BL 3996

QUAD-YEAR	ELEV	DESCRIPTION (INCLUDE QUAD AND YEAR IN DESCRIPTION)	BM NUMBER
LIEBRE (1973)	2536.677	1.5IN IP W/CONC PLUG + BR FLUSH 50FT E + 50FT S C/L INT AVE A + 130TH ST W USE CTR	BL 3997
LIEBRE (1973)	2561.532	CS MON IN WELL 10IN DN @ C/L INT AVE A + 140TH ST W MKD SEC COR 32-33-5-4 T8N T9N R14W USE W EDGE	BL 3998
LIEBRE (1973)	2571.960	CS MON IN WELL @ C/L INT AVE A + 145TH ST W MKD 1/4 COR 32-5 T8N T9N R14W USE NE EDGE	BL 3999
LIEBRE (1973)	2586.134	STANDARD CS BR CAP MON 2IN UP 45FT E + 45FT S C/L INT AVE A + 150TH ST W MKD FAIRMONT BUTTE RM 2 RE 5869 2IN IP 3FT UP 2FT SLY	BL 4000
LIEBRE (1973)	2595.520	RDBM TAG IN CONC COLLAR OF IRRIGATION VALVE 32FT N C/L AVE A + 36FT E C/L FUTURE 155TH ST W	BL 4001
LIEBRE (1973)	2603.308	CS MON IN WELL @ C/L INT AVE A + FUTURE 160TH ST W MKD SEC COR 36 31 1 6 T9N T8N R15W R14W	BL 4002
LIEBRE (1973)	2608.961	2IN IP W/CONC PLUG + T 40FT N + 40FT E C/L INT AVE A + FUTURE 165TH ST W CHIS X ON S EDGE	BL 4003
LIEBRE (1973)	2613.758	STANDARD CS BR CAP MON 2IN UP 42FT S + 42FT E C/L INT AVE A + 170TH ST W MKD FAIRMONT BUTTE RM2 1970 RE 5869	BL 4004
LIEBRE (1973)	2628.500	L + BN IN NE COR CONC SLAB OF IRRIGATION PUMP 34FT E FUTURE 175TH ST W + 186FT N AVE A MKD BM	BL 4005
LIEBRE (1973)	2660.570	STANDARD CS BR CAP MON 4IN UP 44FT N + 42FT W C/L INT AVE A + 190TH ST W MKD FAIRMONT BUTTE RM2 1970 RE 5869	BL 4006
LIEBRE (1973)	2665.268	RDBM MON IN WELL 30FT E C/L 190TH ST W + 0.5MI S/O AVE A @ FUTURE AVE A-8 35FT NE OF PP NO 1309751E 2IN IP 3FT UP 2FT W	BL 4007
LIEBRE (1973)	2720.157	STANDARD CS BR CAP MON 4IN UP 42FT N + 42FT E C/L INT AVE C + 190TH ST W MKD FAIRMONT BUTTE RM1 1970 RE 5869	BL 4008
LIEBRE (1973)	2720.498	STANDARD CS BR CAP MON 4IN UP 42FT N + 42FT W C/L INT AVE C + 190TH ST W MKD FAIRMONT BUTTE RM2 1970 RE 5869	BL 4009
LIEBRE (1973)	2746.714	RDBM MON IN WELL 25FT W C/L 190TH ST W + 0.5MI S/O AVE C @ FUTURE AVE C-8 4FT W/O PP NO 1309597 2IN IP 3FT UP 2FT N	BL 4010
LIEBRE (1973)	2823.167	CSBM MON 6IN UP 50FT N + 30FT E C/L INT 190TH ST W + AVE E MKD BM 117-44A 1972 2IN IP 3FT UP X 2FT W	BL 4011
LIEBRE (1973)	2847.406	CS MON 18IN DN @ C/L INT 190TH ST W + AVE E-8 MKD 1/4 SEC COR 28 27 T8N R15W 2IN IP 3FT UP 2FT E USE S EDGE	BL 4012
LIEBRE (1973)	2873.769	STANDARD CS BR CAP MON FLUSH 30FT N C/L EXISTING PVMT LANCASTER RD + 200FT W C/L PROD 190TH ST W MKD LAKE HUGHES RM2 1971 RE 5869 2IN IP 3FT UP 2FT N	BL 4013

QUAD-YEAR	ELEV	DESCRIPTION (INCLUDE QUAD AND YEAR IN DESCRIPTION)	BM NUMBER
LIEBRE (1973)	2621.819	RDBM TAG IN SW COR CONC SLAB 43FT N + 105FT E C/L INT 170TH ST W + FUTURE AVE A-8	BL 4014
LIEBRE (1973)	2619.398	CS MON IN WELL @ C/L INT 170TH ST W + FUTURE AVE A-8 MKD 1/4 COR 2 1 T8N R15W USE W EDGE	BL 4015
LIEBRE (1973)	2624.948	1.5IN IP W/CONC PLUG + BR 4IN UP 50FT S + 50FT W C/L INT 170TH ST W + FUTURE AVE B CHIS X ON SW EDGE	BL 4016
LIEBRE (1973)	2643.699	2IN IP W/CONC PLUG + CE TAG 3IN UP 50FT N + 50FT E C/L INT 170TH ST W + AVE B-8 CHIS X ON NW EDGE	BL 4017
LIEBRE (1973)	2665.247	CS BM MON 5IN UP 80FT S + 40FT E C/L INT 170TH ST W + FUTURE AVE C MKD BM 117-36B 1972	BL 4018
LIEBRE (1973)	2681.894	1.25IN IP FLUSH 50FT W + 50FT S C/L INT 170TH ST W + FUTURE AVE C-8 CHIS X ON E EDGE	BL 4019
LIEBRE (1973)	2561.933	2IN IP W/CONC PLUG + CE TAG 5IN UP 50FT W + 50FT S C/L INT 140TH ST W + FUTURE AVE C-8 CHIS X ON NE EDGE	BL 4020
LIEBRE (1973)	2559.971	2IN IP W/CONC PLUG + CE TAG 5IN UP 50FT N + 50FT E C/L INT 140TH ST W + FUTURE AVE C-8 CHIS X ON S EDGE	BL 4021
LIEBRE (1973)	2551.762	STANDARD CS BR CAP MON 2IN UP 44FT S + 45FT W C/L INT 140TH ST W + FUTURE AVE C MKD FAIRMONT BUTTE RM2 1970 RE 5869 11FT S/O PP NO 1633974E 2IN IP 3FT UP 2FT E	BL 4022
LIEBRE (1973)	2550.878	STANDARD CS BR CAP MON 2IN UP 42FT S + 45FT E C/L INT 140TH ST W + FUTURE AVE C MKD FAIRMONT BUTTE RM1 1970 RE 5869 6FT SE/O PP NO 1633945E 2IN IP 3FT UP 2FT W	BL 4023
LIEBRE (1973)	2546.620	1.5IN IP W/CONC PLUG + BR 8IN DN 50FT S + 50FT E C/L INT 140TH ST W + FUTURE AVE B-8 12FT SE PP NO 1633933E CHIS X ON E EDGE	BL 4024
LIEBRE (1973)	2548.016	1.5IN IP W/CONC PLUG + BR 8IN DN 50FT N + 50FT W C/L INT 140TH ST W + FUTURE AVE B-8 CHIS X N EDG	BL 4025
LIEBRE (1973)	2553.747	RDBM TAG IN NE COR CONC SLAB OF IRRIGATION PUMP SHED 65FT E C/L 140TH ST W + 52FT S C/L FUTURE AVE B 25FT ELY PP NO 1491176E	BL 4026
LIEBRE (1973)	2556.293	RDBM MON IN WELL 30FT E C/L 140TH ST W + 0.5MI S/O AVE A @ FUTURE AVE A-8 4FT N/O PP NO 1491166E 2IN IP 3FT UP 2FT W	BL 4027
LIEBRE (1973)	3048.798	RDBM MON IN WELL 57FT S + 35FT W C/L INT THREE POINTS RD + LANCASTER RD 60FT NW PP NO 1200372E 2IN IP 3FT UP 2FT E	BL 4028
LIEBRE (1973)	3123.623	CSBM MON 25FT E C/L THREE POINTS RD + 0.5MI S/O LANCASTER RD 2FT E/O PP NO 1200383E MKD BM 111-61 1960 RE5869	BL 4029
LIEBRE (1973)	3132.883	CSBM MON 25FT W C/L THREE POINTS RD + 0.9MI S/O LANCASTER RD 2FT W/O PP NO 1200394E MKD BM 111-60 1960 RE 5869	BL 4030

QUAD-YEAR	ELEV	DESCRIPTION (INCLUDE QUAD AND YEAR IN DESCRIPTION)	BM NUMBER
LIEBRE (1973)	3205.856	RDBM MON 27FT E C/L THREE POINTS RD + 1.5MI S/O LANCASTER RD 2.5FT W/O PP NO 1200308E MKD BM 111-59 1960 RE 5869 2IN IP 3FT UP 2FT W	BL 4031
LIEBRE (1973)	3275.645	CSBM MON 23FT W C/L THREE POINTS RD + 2.1MI S/O LANCASTER RD 2FT W/O PP NO 1938415E MKD BM 111-58 1960 RE 5869	BL 4032
LIEBRE (1973)	3342.563	CSBM MON 41FT W C/L THREE POINTS RD + 2.6MI S/O LANCASTER RD 3.5FT N/O PP NO 1938408E MKD BM 111-57 1960 RE 5869 2IN IP 3FT UP 2FT N	BL 4033
LIEBRE (1973)	3428.414	CSBM MON 34FT E C/L THREE POINTS RD + 27FT N/O C/L PINE CYN RD 3FT S/O PP NO 1200318E MKD BM 111-56 1960 RE 5869 2IN IP 3FT UP 2FT W	BL 4034
LIEBRE (1973)	3429.755	RDBM TAG IN CONC SLAB OF THREE POINTS CAFE (LONG BRANCH) 48FT WLY C/L THREE POINTS RD + 44FT S C/L PINE CYN RD	BL 4035
LIEBRE (1973)	3464.911	RDBM TAG IN CONC FTG OF BARB WIRE FENCE 20FT S C/L PINE CYN RD + 0.5MI W/O THREE POINTS RD ON E SIDE OF DIRT DR TO HIDDEN ACRES HSE NO 26876	BL 4036
LIEBRE (1973)	3465.800	RDBM TAG IN CONC FTG OF GATE POST 30FT N C/L PINE CYN RD + 0.5MI W/O THREE POINTS RD ON W SIDE OF DR TO MOUNTAIN VIEW RANCH HSE NO 27001	BL 4037
LIEBRE (1973)	3551.913	RDBM MON IN WELL 20FT N C/L PINE CYN RD + 1.0MI W/O THREE POINTS RD 5FT N/O LACFD POLE NO 633 2IN IP 3FT UP 2FT N	BL 4038
LIEBRE (1973)	3628.079	CE PROP COR MON 2IN UP 17FT S C/L PINE CYN RD + 1.5MI W/O THREE POINTS RD 306FT W/O SECOMBRE RD MKD PROP COR RE 5869 2IN IP 3FT UP 1FT N	BL 4039
LIEBRE (1973)	3641.157	CE PROP COR MON FLUSH 16FT SLY C/L PINE CYN RD + 1.55MI W/O THREE POINTS RD 560FT W/O C/L SECOMBRE RD MKD PROP COR RE 5869 2IN IP 3FT UP 2FT NELY	BL 4040
LIEBRE (1973)	3810.517	RDBM MON IN WELL 30FT N C/L PINE CYN RD + 2.1MI W/O THREE POINTS RD 22FT E/O DIRT DR TO HINDLAND GUN CLUB 100FT W/O MI POST NO 12.45 2IN IP 3FT UP 2FT SLY	BL 4041
LIEBRE (1973)	2528.194	RDBM MON IN WELL 45FT N C/L AVE D + 159FT W C/L 125TH ST W 10FT E/O PP NO 1443367E 2IN IP 3FT UP 1FT N	BL 4042
LIEBRE (1973)	2822.537	2IN IP W/CONC PLUG SPK + W SET IN CONC FLUSH 50FT S C/L AVE D + ON C/L 225TH ST W PROP 2IN IP 4FT UP 1FT S	BL 4043
LIEBRE (1973)	2845.357	L + T IN NW COR CONC SLAB @ SW COR CIRCLE SPEAR CAFE 125FT N C/L AVE D + 200FT E C/L 230TH ST W	BL 4044
LIEBRE (1973)	2971.167	CALIF STATE DEPT OF WATER RESOURCES MON IN N CB OF CALIF AQUADUCT 21FT W/O E END OF CB 23FT N C/L AVE D + 391FT E C/L 245TH ST W MKD 3136A 1971	BL 4045
LIEBRE (1973)	2971.480	BOLT IN S CB OF CALIF AQUADUCT 24FT E/O W END CB 23FT S C/L AVE D + 301FT E C/L 245TH ST W	BL 4046

QUAD-YEAR	ELEV	DESCRIPTION (INCLUDE QUAD AND YEAR IN DESCRIPTION)	BM NUMBER
LIEBRE (1973)	2903.383	LACS MON 5IN UP 94FT N + 44FT E C/L INT 210TH ST W + LANCASTER RD MKD NEENACH SCHOOL 0-14 RM1 1970 2IN IP 3FT UP 2FT W	BL 4047
LIEBRE (1973)	2903.733	LACS MON 5IN UP 94FT N + 47FT W C/L INT 210TH ST W + LANCASTER RD MKD NEENACH SCHOOL 0-14 RM2 1970 2IN IP 3FT UP 2FT E	BL 4048
LIEBRE (1973)	2861.026	RDBM TAG 2FT N/O S END HDWL 25FT N C/L LANCASTER RD + 22FT E/O DR TO HSE NO 18303 0.6MI E/O 190TH ST W	BL 4049
LIEBRE (1973)	2902.894	CS MON 20IN DN 84FT W + 150FT S C/L LANCASTER RD + FUTURE 195TH ST W MKD 1/4 SEC COR 28 33 T8N R15W 2IN IP 3FT UP 2FT E	BL 4050
LIEBRE (1973)	2952.978	CALIF STATE DEPT OF WATER RESOURCES MON 5IN DN 50FT WLY C/L EXISTING PVMT LANCASTER RD + 0.5MI W/O FUTURE 195TH ST W ANGLE IRON MKR 3FT UP 1FT N MKD M 2 171 USE E EDGE OF CTR BUTTON	BL 4051
LIEBRE (1973)	2518.176	USC+GS MON 2IN UP 28FT N/O C/L AVE I + 315FT E/O C/L 115TH ST W MKD B 1220 1971	BL 4052
LIEBRE (1973)	2940.999	RDBM TAG IN FTG OF FENCE POST 60FT E C/L MUNZ RANCH RD 10FT S C/L ACCESS RD TO STATE OF CALIF AQUADUCT 1.6MI N/O ELIZABETH LAKE RD	BL 4053
<del>LIEBRE (1973)</del>	<del>3332.549</del>	<del>CS MON 2IN UP 29FT N + 41FT E C/L INT ELIZABETH LAKE RD + JOHNSON RD 40FT W C/L DRWY TO ELIZABETH MISSION CATHOLIC CHURCH MKD PC 21 RE63</del>	<del>BL 4054</del>
LIEBRE (1973)	2859.925	1.5IN IP W/CONC PLUG + BR 10IN DN @ BC 37FT N/O JOHNSON RD + 218FT W C/L PROD 110TH ST W 96FT E PP NO 1897439E USE S EDGE	BL 4055
LIEBRE (1973)	3972.806	RDBM TAG IN CONC FTG OF 2IN IP GATE POST ON W SIDE OF PVT DR DIRT 24FT N C/L PINE CYN RD + 2.65MI W/O THREE POINTS RD	BL 4056
LIEBRE (1973)	3831.713	RDBM TAG IN LARGE ROCK 27FT N C/L PINE CYN RD + 3.1MI W/O THREE POINTS RD	BL 4057
LIEBRE (1973)	3831.643	RDBM MON IN WELL 22FT S C/L PINE CYN RD + 3.1MI W/O THREE POINTS RS 2IN IP 3FT UP 2FT N	BL 4058
LIEBRE (1973)	3827.169	RDBM MON IN WELL 25FT N C/L PINE CYN RD + 3.6MI W/O THREE POINTS RD 14FT NE OF FIRE POLE + 13FT + 13FT N/O 48IN OAK TREE 2IN IP 3FT UP 2FT S	BL 4059
LIEBRE (1973)	3966.636	RDBM MON IN WELL 27FT S C/L PINE CYN RD + 4.0MI W/O THREE POINTS RD 27FT E C/L DIRT RD TO CAMP GROUND HORSE TRAIL 15FT E/O FIRE CALL BOX NO 77-5 2IN IP 3FT UP 2FT N	BL 4060
LIEBRE (1973)	3965.863	RDBM MON IN WELL 27FT S C/L PINE CYN RD + 4.0MI W/O THREE POINTS RD 20FT W/O DIRT RD TO CAMP GROUND HORSE TRAIL 5FT W/O HORSETRAIL SIGN 2IN IP 3FT UP 2FT N	BL 4061
LIEBRE (1973)	3802.172	RDBM MON IN WELL 20FT N C/L PINE CYN RD + 4.6MI W/O THREE POINTS RD @ TOP OF SMALL HILL 5FT SE/O FIRE POLE 2IN IP 3FT UP 2FT S	BL 4062

QUAD-YEAR	ELEV	DESCRIPTION (INCLUDE QUAD AND YEAR IN DESCRIPTION)	BM NUMBER
LIEBRE (1973)	3770.108	RDBM TAG IN CONC FTG OF 1.5IN STEEL SIGN POST 17FT N C/L PINE CYN RD + 5.1MI W/O THREE POINTS RD 7FT N/O FIRE POLE	BL 4063
LIEBRE (1973)	3769.690	RDBM TAG IN WELL 20FT S C/L PINE CYN RD + 5.1MI W/O THREE POINTS RD 10FT S/O 30IN OAK TREE 2IN IP 3FT UP 2FT N	BL 4064
LIEBRE (1973)	3664.314	RDBM TAG IN CONC WALL OF CATTLE GUARD @ ENT TO RANCHO CORONA DEL VALLE 37FT WLY C/L PINE CYN RD + 5.6MI W/O THREE POINTS RD 20FT SW/O FIRE CALL BOX NO 77-1	BL 4065
LIEBRE (1973)	3584.732	RDBM MON IN WELL 35FT N C/L PINE CYN RD + 6.0MI W/O THREE POINTS RD 20FT S/O PP NO 1185314E 2IN IP 3FT UP 2FT S	BL 4066
LIEBRE (1973)	3563.266	RDBM MON IN WELL 25FT S C/L PINE CYN RD + 6.5MI W/O THREE POINTS RD 35FT SE/O MILE MKR 16.95 80FT E/O PP NO 1185324E 2IN IP 3FT UP 2FT N	BL 4067
LIEBRE (1973)	3746.051	RDBM MON IN WELL 30FT W C/L PINE CYN RD + 7.1MI W/O THREE POINTS RD 2IN IP 3FT UP 2FT E	BL 4068
LIEBRE (1973)	3841.845	2IN IP W/CONC PLUG + RCE TAG 11467 2IN UP 18FT W C/L PINE CYN RD + 7.7MI W/O THREE POINTS RD 25FT SE/O COR OF BARN CHANNEL IP 4FT UP 1FT W MKD LINE	BL 4069
LIEBRE (1973)	3866.755	RDBM TAG IN CONC FTG OF FENCE POST @ CONC WK TO HSE NO 32633 15FT W C/L PINE CYN RD + 7.75MI W/O THREE POINTS RD	BL 4070
LIEBRE (1973)	4009.583	CSBM MON 4IN UP 25FT W C/L OLD RIDGE RTE RD + 19FT S C/L PINE CYN RD MKD BM 208-9 1968 2IN IP 3FT UP 2FTE	BL 4071
LIEBRE (1973)	4008.376	RDBM TAG IN CTR CONC HDWL OF C B NO 2.55 20FT W C/L OLD RIDGE RTE RD + 27FT N C/L PINE CYN RD	BL 4072
LIEBRE (1973)	3931.991	USC+GS MON 3IN UP 50FT N C/L OLD RIDGE RTE RD + 0.45MI N/O PINE CYN RD 1.9MI SELY LANCASTER RD MKD D-370 1953 SURVEY MKR 3FT UP 1.5FT SE	BL 4073
LIEBRE (1973)	3896.350	USC+GS MON SET VERTICALLY IN FACE OF CUT BANK 3FT ABOVE LEVEL OF RD 17FT S C/L OLD RIDGE RTE RD + 1.75MI SELY LANCASTER RD 252FT ELY RD SIGN NO 2.05 MKD U-991-1965	BL 4074
LIEBRE (1973)	3823.888	CSBM MON IN CONC HDWL OF CULV NO 1.80 21FT NLY C/L OLD RIDGE RTE RD + 1.55MI SELY LANCASTER RD 1.5FT E/O W END HDWL MKD BM 208-6 1968	BL 4075
LIEBRE (1973)	3785.235	CS MON FLUSH 28FT E C/L OLD RIDGE RD + 1.4MI SELY LANCASTER RD MKD LA LIEBRE RANCH E-15 1971 RE 7078 2IN IP 3FT UP 3FT W	BL 4076
LIEBRE (1973)	3768.732	CSBM MON 5IN DN 32FT N C/L OLD RIDGE RTE RD + 1.35MI SLY LANCASTER RD MKD BM 208-5 1968 RE5869 2IN IP 3FT UP 2FT S + 2FT E	BL 4077
LIEBRE (1973)	3667.943	CSBM MON 2IN UP 58FT SLY C/L OLD RIDGE RTE RD + 1.0MI SELY LANCASTER RD 13FT ELY/O 5FT OAK TREE MKD 208-4 1968 2IN IP 3FT UP 2FT N	BL 4090

QUAD-YEAR	ELEV	DESCRIPTION (INCLUDE QUAD AND YEAR IN DESCRIPTION)	BM NUMBER
LIEBRE (1973)	3593.317	USC+GS MON 8IN UP 54FT SLY C/L OLD RIDGE RTE RD + 0.7MI SELY/O LANCASTER RD MKD X-53 1926 SURVEY MKR 1.5FT UP 1FT SLY	BL 4091
LIEBRE (1973)	3509.743	CSBM MON IN CONC HDWL NO 0.70 23FT SLY C/L OLD RIDGE RTE RD + 0.5MI SELY LANCASTER RD MKD BM 208-2 1968 RE 5869	BL 4092
LIEBRE (1973)	3451.215	CSBM MON IN SLY CONC HDWL OF CULV NO 0.50 26FT SLY C/L OLD RIDGE RTE RD + 0.2MI SELY LANCASTER RD MKD BM 208-1 1968 RE 5869	BL 4093
LIEBRE (1973)	3377.762	RDBM TAG IN CONC HDWL @ INT 87FT SLY LANCASTER RD + 12FT S/O EDGE CONC PVMT OF OLD RIDGE RTE RD 10FT NELY PP NO 1061952E	BL 4094
LIEBRE (1973)	2952.964	CSBM MON 5IN UP 35FT N C/L LANCASTER RD + 0.5MI E/O 235TH ST W MKD BM 102-54A 1972 2IN IP 3FT UP 2FT S	BL 4095
LIEBRE (1973)	2966.926	SPK + L 1FT W/O E END CONC CB OF BRIDGE OVER THE CALIF AQUADUCT 15FT S C/L LANCASTER RD + 214FT W C/L 235TH ST W	BL 4096
LIEBRE (1973)	2967.507	STATE OF CALIF DEPT OF WATER RESOURCES MON 1.5FT W/O E END CONC WK 249FT W C/L 235TH ST W + 16FT N C/L LANCASTER RD MKD 3149-A 1971	BL 4097
LIEBRE (1973)	3005.772	CSBM MON 6IN UP 45FT WLY C/L 245TH ST W + 0.45MI S/O AVE D NR MILE POST 26.66 MKD BM 102-57A 1972 2IN IP 3FT UP 2FT ELY	BL 4098
LIEBRE (1973)	2989.245	RDBM TAG IN CONC FTG OF 4IN STEEL FENCE POST 50FT N C/L LANCASTER RD + 105FT W C/L 270TH ST W @ SE PROP COR OF HSE NO 27011 5FT S/O PP NO 1847251E	BL 4100
LIEBRE (1973)	3039.171	RDBM TAG IN CONC HDWL 1FT N/O S END 27FT S C/L LANCASTER RD + 0.15MI W/O MARGLO ST DIRT 37FT NE/O PP NO 1123692E	BL 4101
LIEBRE (1973)	3021.380	RDBM TAG IN CTR CONC HDWL 22FT S C/L LANCASTER RD + 35FT E C/L 290TH ST W (DIRT) @ DIRT DRIVE TO HSE NO 29300	BL 4102
LIEBRE (1973)	3044.207	RDBM TAG IN CTR OF CONC HDWL 22FT S C/L LANCASTER RD + 135FT W C/L 300TH ST W	BL 4103
LIEBRE (1973)	3114.850	RDBM TAG IN CTR OF CONC HDWL OF BRIDGE NO 53- 545 22FT S C/L LANCASTER RD + 125FT E/O DIRT RD W/CATTLE GUARD 3.3MI E/O OLD RIDGE RTE RD	BL 4104
LIEBRE (1973)	3168.854	RDBM TAG IN NE COR CONC HDWL OF CULV 22FT S C/L LANCASTER RD + 2.3MI E/O OLD RIDGE RTE RD	BL 4105
LIEBRE (1973)	3287.505	RDBM TAG IN CTR CONC HDWL NO A-75 78 22FT N C/L LANCASTER RD + 1.3MI E/O OLD RIDGE RTE RD 105FT E/O PP NO 1061984E	BL 4106
LIEBRE (1973)	3407.996	USC+GS MON IN ELY END OF CONC HDWL OF BRIDGE NO 53-5 23FT N C/L LANCASTER RD + 0.3MI E/O OLD RIDGE RTE RD MKD H1044 1960	BL 4107

QUAD-YEAR	ELEV	DESCRIPTION (INCLUDE QUAD AND YEAR IN DESCRIPTION)	BM NUMBER
LIEBRE (1973)	3377.761	RDBM TAG IN CONC HDWL 87FT SLY C/L LANCASTER RD + 12FT S/O EDGE CONC PVM <b>OUT</b> OLD RIDGE RTE RD 10FT NELY PP NO 1061952E	BL 4108
LIEBRE (1973)	3322.768	RDBM TAG IN SE COR OF HDWL OF CATTLE GUARD 60FT S C/L LANCASTER RD + 0.6MI W/O OLD RIDGE RTE RD OPPOSITE MAIL BOX NO 67	BL 4109
LIEBRE (1973)	3327.860	STATE OF CALIF DEPT OF WATER RESOURCES MON 6IN UP 140FT S C/L LANCASTER RD + 0.6MI W/O OLD RIDGE RTE RD MKD ORP-7 1968 MKR POST 3FT UP 3FT S	BL 4110
LIEBRE (1973)	3327.764	RDBM TAG IN CONC FTG OF FENCE POST @ NW COR P/L HSE NO 68 (CIRCLE K RANCH) 21FT S C/L LANCASTER RD 110FT W/O WLY DR TO HSE 1.1MI W/O OLD RIDGE RTE RD	BL 4111
LIEBRE (1973)	3322.186	USC+GS MON IN CONC HDWL NO 115 65 28FT N C/L LANCASTER RD + 1.3MI W/O OLD RIDGE RTE RD MKD LI219 1971	BL 4112
LIEBRE (1973)	3329.697	RDBM TAG IN CONC FTG OF FENCE POST 37FT S C/L LANCASTER RD + 1.9MI W/O OLD RIDGE RTE RD 12FT E C/L MAC DR INTO STATE OF CALIF PROPERTY	BL 4113
LIEBRE (1973)	3330.672	STATE OF CALIF DEPT OF WATER RESOURCES MON 5IN UP 40FT N C/L LANCASTER RD + 1.9MI W/O OLD RIDGE RTE RD 107FT W/O MAC DR INTO STATE OF CAL PROPERTY 17FT NW PP NO 1061900E MKD OC W2-58 1968 SURVEY MKR 2FT UP 2FT W	BL 4114
LIEBRE (1973)	3330.274	USC+GS MON FLUSH 45FT N C/L N BARREL LANCASTER RD + 2.35MI W/O OLD RIDGE RTE RD 45FT W/O PP NO 1061893E MKD Z 973 1964 RESET 1965 SURVEY MKR POST 2FT UP 1FT E	BL 4115
LIEBRE (1973)	3329.232	USC+GS MON 2IN UP 77FT N C/L N BARREL LANCASTER RD + 2.4MI W/O OLD RIDGE RTE RD 95FT E/O PP NO 1061891E MKD X-973 1964 RESET 1965 SURVEY MKR POST 2FT UP 1.5FT E	BL 4116
LIEBRE (1973)	3329.081	USC+GS MON 5IN UP 94FT N C/L N BARREL LANCASTER RD + 2.45MI W/O OLD RIDGE RTE RD 57FT W/O PP NO 1061891E MKD W 973 1964 RESET 1965 SURVEY MKR POST 2FT UP 2FT W	BL 4117
LIEBRE (1973)	3325.895	USC+GS MON FLUSH 106FT N C/L N BARREL LANCASTER RD + 2.5MI W/O OLD RIDGE RTE RD 4FT W/O PP NO 1061890E MKD U 973 1964 RESET 1965 SURVEY MKR POST 2FT UP 1.5FT W	BL 4118
LIEBRE (1973)	3503.262	CSBM MON 4IN UP 37FT N C/L GORMAN POST RD + 0.9MI W/O LANCASTER RD MKD BM 102-88A 1968 2IN IP 3FT UP 2FT S	BL 4119
LIEBRE (1973)	3544.112	USC+GS MON 5IN UP 39FT S C/L GORMAN POST RD + 3.0MI W/O LANCASTER RD 30FT W/O IP NO 10-41 MKD H 452 1953 2IN IP 3FT UP 1.5FT W	BL 4120
LIEBRE (1973)	3646.297	USC+GS MON 40FT N C/L GORMAN POST RD + 1.2MI E/O GORMAN SCHOOL RD 16FT NE/O TP NO 9A-406P MKD E 452 1953 SURVEY MKR POST 2FT W	BL 4121



QUAD-YEAR	ELEV	DESCRIPTION (INCLUDE QUAD AND YEAR IN DESCRIPTION)	BM NUMBER
LIEBRE (1973)	3747.749	RDBM TAG IN CONC WALL OF DROP INLET NO 4.70 17FT N C/L GORMAN POST RD + 0.5MI E/O GORMAN SCHOOL RD 15FT W/O PP NO 1699131E	BL 4122
LIEBRE (1973)	3782.535	USC+GS MON 5IN UP 89FT N C/L GORMAN POST RD + 0.45MI E/O GORMAN SCHOOL RD 11FT W/O TP NO 21- 396P 125FT ELY OF SE COR OF OLD MAINTENANCE BLDG MKD Z 368 1953 SURVEY MKR POST 2FT W	BL 4123
LIEBRE (1973)	3814.520	L + T IN CB 48FT N C/L GORMAN POST RD @ C/L PROD OF GORMAN SCHOOL RD	BL 4124
LIEBRE (1973)	3816.653	RDBM TAG IN CONC FTG OF LIGHT STANDARD 177FT S C/L GORMAN POST RD + 42FT W C/L GORMAN SCHOOL RD @ SLY DR TO CHEVRON GAS STATION	BL 4125
LIEBRE (1973)	3906.483	USC+GS MON IN CONC HDWL NO 3.20 1FT E/O W END 48FT S C/L PEACE VALLEY RD + 0.45MI W/O GORMAN SCHOOL RD MKD N 1219 1971	BL 4126
LIEBRE (1973)	3826.852	COPPER WIRE TOP 6IN X 6IN CONC POST 6 IN UP 1 FT S/O LACO SUR BRASS CAP MON MKD (KERN CO LA CO BDY) 40 FT E LY C/L PEACE VALLEY RD	BL 4360
LIEBRE (1973)	3989.564	STATE OF CAL DIV HWY BRASS CAP MON MKD ( EC C/L 738+67.82 AH 738+25.20 BK) CTR DIRT DIVIDER 33FT S LY C B W/MKR POST 0.70 PEACE VALLEY RD, 0.6 MI S/O KERN CO LINE	BL 4361
LIEBRE (1973)	4054.860	STATE OF CAL DIV HWY BRASS CAP MON MKD (727+5115 BC C/L) CTR DIRT DIVIDER, 1.4 FT S/O S EDGE CONC C B 50 FT E LY MKR POST 0.90 ON W LY EDGE SO BARREL PEACE VALLEY RD 0.8 MI S LY KERN CO LINE	BL 4362
LIEBRE (1973)	4180.529	LACE B MON MKD ( BM 102-107 1968 RE 5869) IN SW COR BRIDGE 53-1779 OVER FRWY, 58FT E LY APPROX C/L PEACE VALLEY RD 1.3 MI S LY KERN CO LINE	BL 4363
LIEBRE (1973)	4095.663	LACE B MON MKD ( BM102 106 1968 RE 5869) IN S LY CONC HDWL 2 FT E/O W END 53FT E LY OF APPROX C/L PEACE VALLEY RD 1.6 MI S LY KERN CO LINE E LY MKR POST 2.00 ON E LY EDGE PVMT	BL 4364